

AS85049/19

BACKSHELL, NONENVIRONMENTAL, STRAIGHT, RFI/EMI (FOR MIL-DTL-38999 SERIES III AND IV CONNECTORS)

PART NUMBER DEVELOPMENT

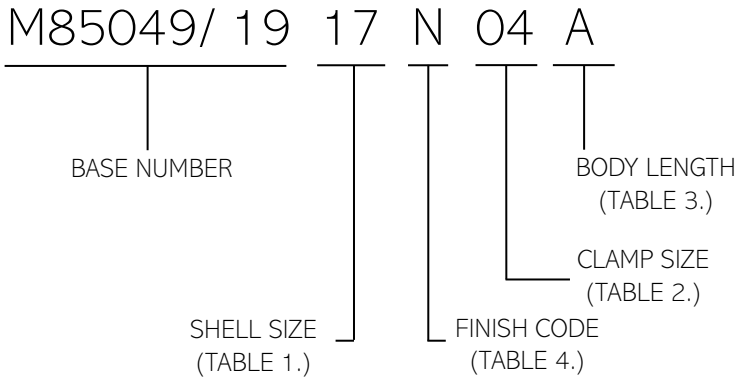

SHELL SIZE	MIN CLAMP SIZE	MAX CLAMP SIZE	A DIM. MAX	THREAD
9	1	2	.750 (19.1)	M12X1.0-6H
11	1	3	.850 (21.6)	M15X1.0-6H
13	2	4	1.000 (25.4)	M18X1.0-6H
15	2	5	1.100 (27.9)	M22X1.0-6H
17	2	6	1.250 (31.8)	M25X1.0-6H
19	3	7	1.400 (35.6)	M28X1.0-6H
21	3	8	1.500 (38.1)	M31X1.0-6H
23	3	9	1.650 (41.9)	M34X1.0-6H
25	4	10	1.750 (44.5)	M37X1.0-6H

CLAMP SIZE	CABLE RANGE MIN	CABLE RANGE MAX	Y DIM MAX
1	.062 (1.57)	.125 (3.18)	.800 (20.3)
2	.125 (3.18)	.250 (6.35)	1.000 (25.4)
3	.250 (6.35)	.375 (9.53)	1.100 (27.9)
4	.312 (7.92)	.500 (12.70)	1.200 (30.5)
5	.437 (11.10)	.625 (15.88)	1.250 (31.8)
6	.562 (14.27)	.750 (19.05)	1.400 (35.6)
7	.687 (17.45)	.875 (22.23)	1.500 (38.1)
8	.812 (20.62)	1.000 (25.40)	1.650 (41.9)
9	.937 (23.80)	1.125 (28.58)	1.750 (44.5)
10	1.062 (26.97)	1.250 (31.75)	1.900 (48.3)

CODE	LENGTH ±.032 (.810)
STANDARD	1.500 (38.1)
A	2.500 (63.5)
B	3.500 (88.9)
C	4.500 (114.3)

CODE	DESCRIPTION
N	ELECTROLESS NICKEL
W	CADMIUM, OLIVE DRAB
X	NICKEL FLUOROCARBON POLYMER
Z	ZINC NICKEL

OMIT FOR STANDARD.

MATERIAL: ALUMINUM ALLOY IN ACCORDANCE WITH AS85049.

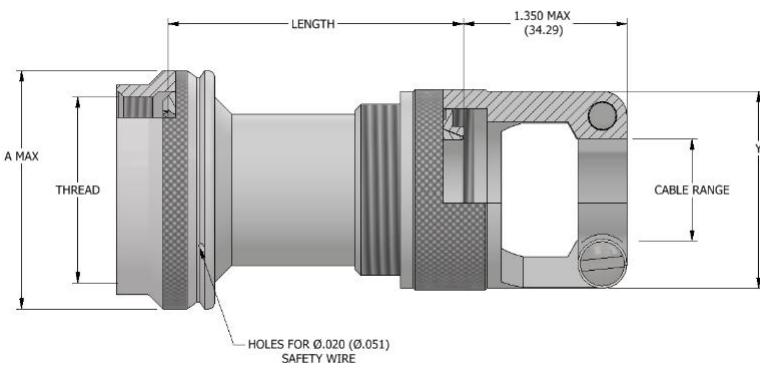

NOTES:

- 1.METRIC DIMENSIONS (mm) ARE IN PARENTHESES.
- 2.FOR COMPLETE DIMENSIONS, SEE THE APPLICABLE MILITARY SPECIFICATION.
- 3."CABLE RANGE" INDICATES THE ACCEPTABLE SIZE RANGE FOR THE CABLE OR WIRE BUNDLE. THE DIMENSIONS PROVIDED ARE NOT INTENDED FOR INSPECTION USE.



AS85049/20
BACKSHELL, STRAIGHT, RFI/EMI
 (FOR MIL-DTL-38999 SERIES III AND IV CONNECTORS)

PART NUMBER DEVELOPMENT

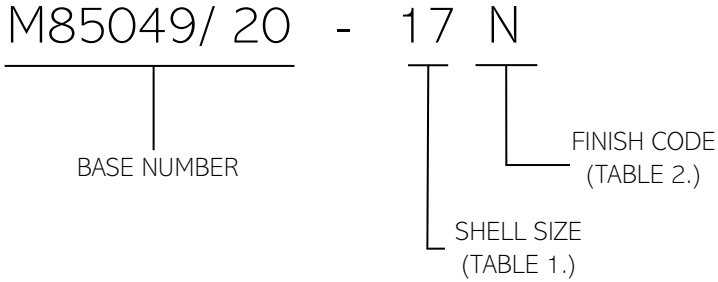

TABLE 1. SHELL SIZE AND DIMENSIONS

SHELL SIZE	A DIA MAX	B DIA MAX	C ±.015 DIA	M85049/26-2 CRIMP RING (REF)	THREAD
9	.750 (19.1)	.347 (8.81)	.250 (6.35)	-8	M12X1.0-6H
11	.850 (21.6)	.498 (12.65)	.325 (8.26)	-10	M15X1.0-6H
13	1.000 (25.4)	.510 (12.95)	.420 (10.67)	-12	M18X1.0-6H
15	1.100 (27.9)	.630 (16.00)	.540 (13.72)	-14	M22X1.0-6H
17	1.250 (31.8)	.760 (19.30)	.670 (17.02)	-16	M25X1.0-6H
19	1.400 (35.6)	.890 (22.61)	.789 (20.04)	-18	M28X1.0-6H
21	1.500 (38.1)	1.010 (25.65)	.914 (23.22)	-20	M31X1.0-6H
23	1.650 (41.9)	1.130 (28.70)	1.039 (26.39)	-22	M34X1.0-6H
25	1.750 (44.5)	1.202 (30.53)	1.112 (28.24)	-24	M37X1.0-6H

TABLE 2. PLATING CODE

CODE	DESCRIPTION
N	ELECTROLESS NICKEL
W	CADMIUM OLIVE DRAB
X	NICKEL FLUOROCARBON POLYMER
Z	ZINC NICKEL

MATERIAL: ALUMINUM ALLOY IN ACCORDANCE WITH AS85049.

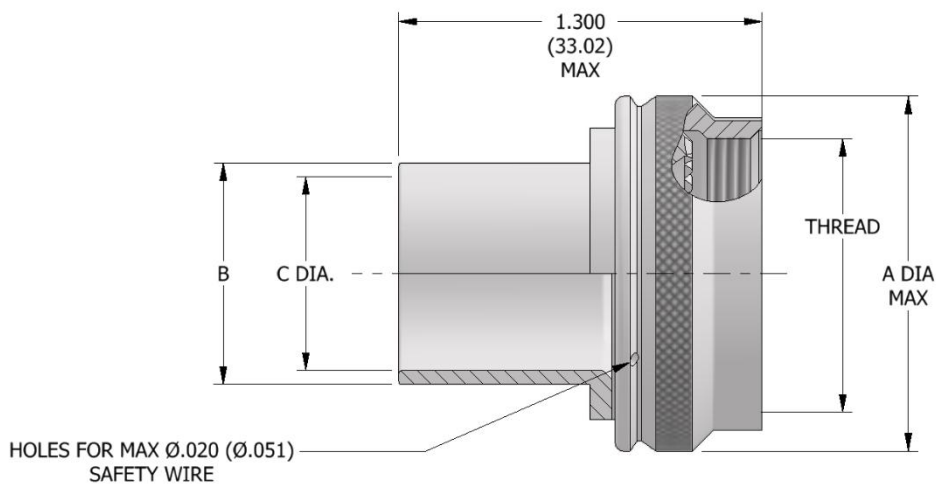

NOTES:

- 1.METRIC DIMENSIONS (mm) ARE IN PARENTHESES.
- 2.FOR COMPLETE DIMENSIONS, SEE THE APPLICABLE MILITARY SPECIFICATION.



AS85049/21

BACKSHELL, NONENVIRONMENTAL, STRAIGHT, RFI/EMI

(FOR MIL-DTL-38999 SERIES III AND IV CONNECTORS)

PART NUMBER DEVELOPMENT

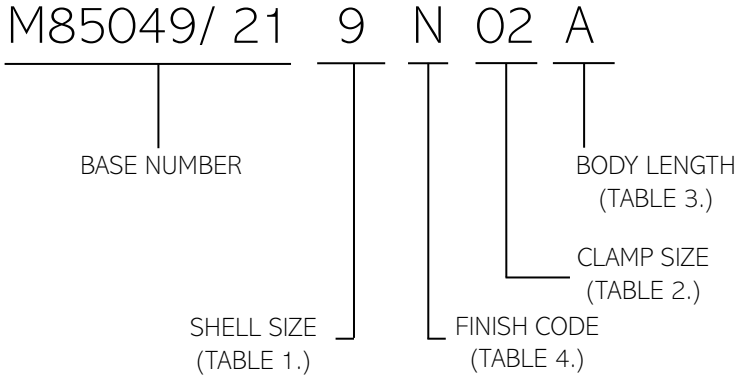

TABLE 1. SHELL SIZE AND CLAMP SIZE				
SHELL SIZE	MIN CLAMP SIZE	MAX CLAMP SIZE	A MAX DIA	THREAD
9	1	2	.750 (19.1)	M12X1.0-6H
11	1	3	.850 (21.6)	M15X1.0-6H
13	2	4	1.000 (25.4)	M18X1.0-6H
15	2	5	1.100 (27.9)	M22X1.0-6H
17	2	6	1.250 (31.8)	M25X1.0-6H
19	3	7	1.400 (35.6)	M28X1.0-6H
21	3	8	1.500 (38.1)	M31X1.0-6H
23	3	9	1.650 (41.9)	M34X1.0-6H
25	4	10	1.750 (44.5)	M37X1.0-6H

TABLE 2. CLAMP SIZE AND DIMENSIONS			
CLAMP SIZE	CABLE RANGE MIN	CABLE RANGE MAX	Y DIM MAX
1	.062 (1.57)	.125 (3.18)	.800 (20.3)
2	.125 (3.18)	.250 (6.35)	1.000 (25.4)
3	.250 (6.35)	.375 (9.53)	1.100 (27.9)
4	.312 (7.92)	.500 (12.70)	1.200 (30.5)
5	.437 (11.10)	.625 (15.88)	1.250 (31.8)
6	.562 (14.27)	.750 (19.05)	1.400 (35.6)
7	.687 (17.45)	.875 (22.23)	1.500 (38.1)
8	.812 (20.62)	1.000 (25.40)	1.650 (41.9)
9	.937 (23.80)	1.125 (28.58)	1.750 (44.5)
10	1.062 (26.97)	1.250 (31.75)	1.900 (48.3)

TABLE 3. ACCESSORY BODY LENGTH	
CODE	LENGTH ±.032 (.810)
STANDARD	1.500 (38.1)
A	2.500 (63.5)
B	3.500 (88.9)
C	4.500 (114.3)

TABLE 4. PLATING CODE	
CODE	DESCRIPTION
A	BLACK ANODIZE, CLASS 2
N	ELECTROLESS NICKEL
W	CADMIUM, OLIVE DRAB
X	NICKEL FLUOROCARBON POLYMER
Y	PURE DENSE ELECTRODEPOSITED
Z	ZINC NICKEL

MATERIAL: ALUMINUM ALLOY IN ACCORDANCE WITH AS85049.

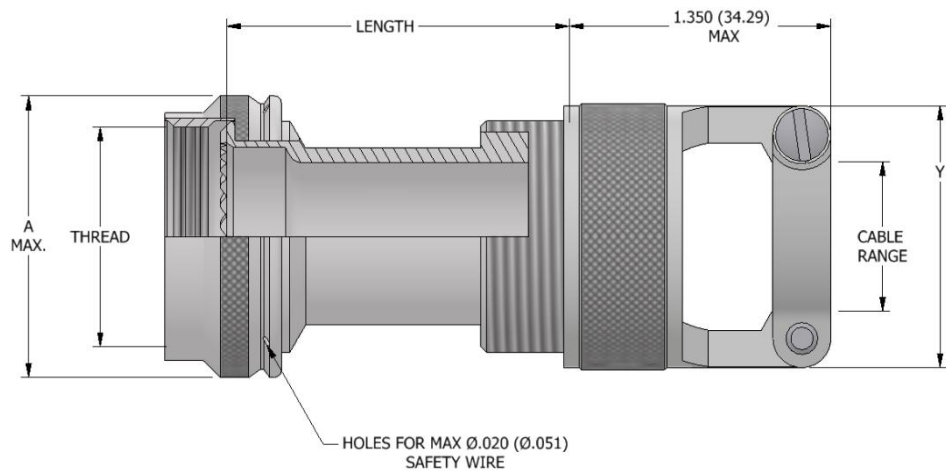

NOTES:

1. METRIC DIMENSIONS (mm) ARE IN PARENTHESES.
2. FOR COMPLETE DIMENSIONS, SEE THE APPLICABLE MILITARY SPECIFICATION.
3. "CABLE RANGE" INDICATES THE ACCEPTABLE SIZE RANGE FOR THE CABLE OR WIRE BUNDLE. THE DIMENSIONS PROVIDED ARE NOT INTENDED FOR INSPECTION USE.



AS85049/29

BACKSHELL, NONENVIRONMENTAL, STRAIGHT

(FOR MIL-DTL-38999 SERIES I AND II CONNECTORS)

PART NUMBER DEVELOPMENT

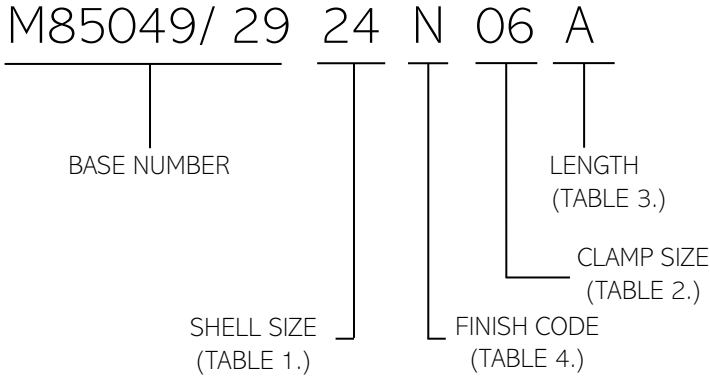

TABLE 1. SHELL SIZE AND CLAMP SIZE			
SHELL SIZE	MIN CLAMP SIZE	MAX CLAMP SIZE	THREAD
8	1	2	0.4375-28
10	1	3	0.5625-24
12	2	4	0.6875-24
14	2	5	0.8125-20
16	2	6	0.9375-20
18	3	7	1.0625-18
20	3	8	1.1875-18
22	3	9	1.3125-18
24	4	10	1.4375-18

TABLE 3. LENGTH	
CODE	LENGTH ±.032 (.810)
STANDARD	1.000 (25.4)
A	2.000 (50.8)
B	3.000 (76.2)
C	4.000 (101.6)

TABLE 4. PLATING CODE	
CODE	DESCRIPTION
A	BLACK ANODIZE, CLASS 2
N	ELECTROLESS NICKEL
W	CADMIUM, OLIVE DRAB
X	NICKEL FLUOROCARBON POLYMER
Y	PURE DENSE ELECTRODEPOSITED
Z	ZINC NICKEL

TABLE 2. CLAMP SIZE AND DIMENSIONS			
CLAMP SIZE	CABLE RANGE MIN	CABLE RANGE MAX	Y DIM MAX
1	.062 (1.57)	.125 (3.18)	.781 (19.84)
2	.125 (3.18)	.250 (6.35)	.969 (24.61)
3	.250 (6.35)	.375 (9.53)	1.062 (26.97)
4	.312 (7.92)	.500 (12.70)	1.156 (29.36)
5	.437 (11.10)	.625 (15.88)	1.250 (31.75)
6	.562 (14.27)	.750 (19.05)	1.375 (34.92)
7	.687 (17.45)	.875 (22.23)	1.500 (38.10)
8	.812 (20.62)	1.000 (25.40)	1.625 (41.28)
9	.937 (23.80)	1.125 (28.58)	1.750 (44.45)
10	1.062 (26.97)	1.250 (31.75)	1.875 (47.62)

OMIT FOR STANDARD.

MATERIAL: ALUMINUM ALLOY IN ACCORDANCE WITH AS85049.

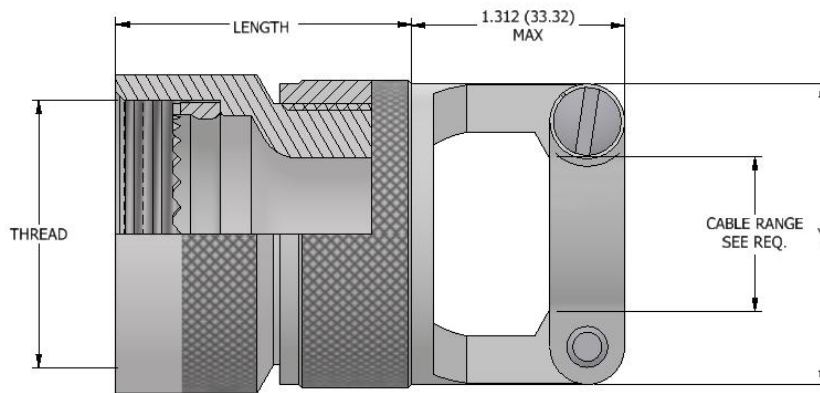

NOTES:

- 1.METRIC DIMENSIONS (mm) ARE IN PARENTHESES.
- 2.FOR COMPLETE DIMENSIONS, SEE THE APPLICABLE MILITARY SPECIFICATION.
- 3.“CABLE RANGE” INDICATES THE ACCEPTABLE SIZE RANGE FOR THE CABLE OR WIRE BUNDLE. THE DIMENSIONS PROVIDED ARE NOT INTENDED FOR INSPECTION USE.



AS85049/33

BACKSHELL, NONENVIRONMENTAL, STRAIGHT, SHIELDED TERMINATION

(FOR MIL-DTL-38999 SERIES I AND II CONNECTORS)

PART NUMBER DEVELOPMENT

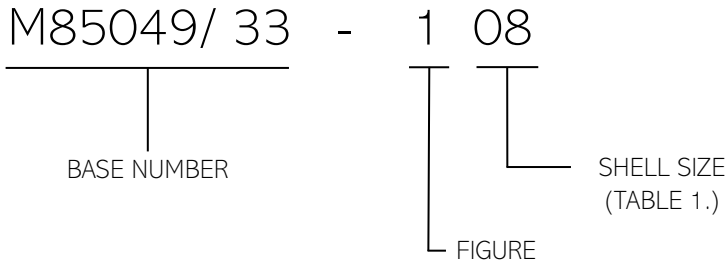
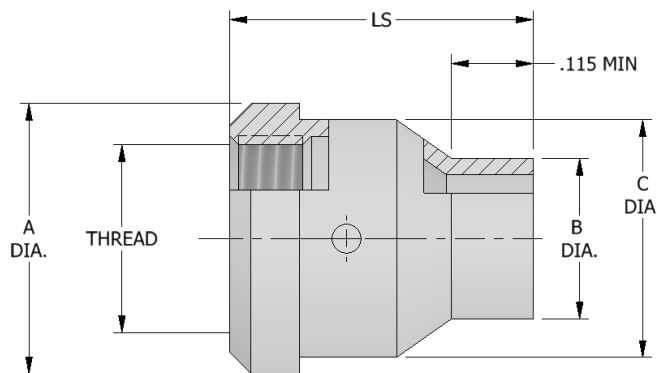

TABLE 1. SHELL SIZE AND DIMENSIONS

ADAP. SHELL SIZE	A MAX DIA.	B MAX DIA.	C MAX DIA.	LS MAX	THREAD UNEF CLASS 2B
8	.594 (15.09)	.359 (9.12)	.516 (13.11)	.844 (21.44)	7/16-28
10	.719 (18.26)	.406 (10.31)	.641 (16.28)	.969 (24.61)	9/16-24
12	.844 (21.44)	.500 (12.70)	.766 (19.46)	1.094 (27.79)	11/16-24
14	.969 (24.61)	.578 (14.68)	.891 (22.63)	1.156 (29.36)	13/16-20
16	1.094 (27.79)	.641 (16.28)	1.016 (25.81)	1.219 (30.96)	15/16-20
18	1.219 (30.96)	.688 (17.48)	1.141 (28.98)	1.344 (34.14)	1 1/16-18
20	1.344 (34.14)	.734 (18.64)	1.265 (32.13)	1.469 (37.31)	1 3/16-18
22	1.469 (37.31)	.796 (20.22)	1.391 (35.33)	1.594 (40.49)	1 5/16-18
24	1.594 (40.49)	.859 (21.82)	1.516 (38.51)	1.719 (43.66)	1 7/16-18



NOTES:

- 1.METRIC DIMENSIONS (mm) ARE IN PARENTHESES.
- 2.FOR COMPLETE DIMENSIONS, SEE THE APPLICABLE MILITARY SPECIFICATION.
- 3.MATERIAL: ALUMINUM ALLOY IN ACCORDANCE WITH AS85049.



AS85049/33

BACKSHELL, NONENVIRONMENTAL, STRAIGHT, SHIELDED TERMINATION

(FOR MIL-DTL-38999 SERIES I AND II CONNECTORS)

PART NUMBER DEVELOPMENT

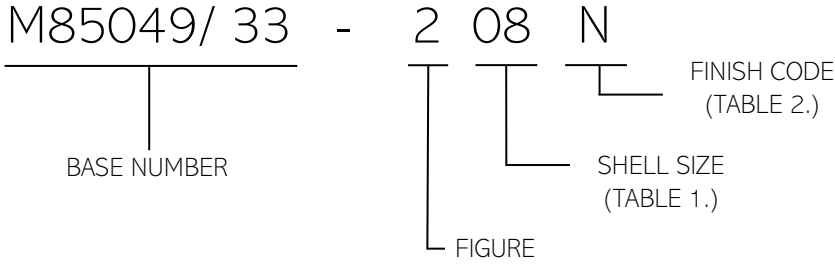

CODE	DESCRIPTION
N	ELECTROLESS NICKEL
W	CADMIUM, OLIVE DRAB
X	NICKEL FLUOROCARBON POLYMER
Z	ZINC NICKEL

MATERIAL: ALUMINUM ALLOY IN ACCORDANCE WITH AS85049.

TABLE 1. SHELL SIZE AND DIMENSIONS

ADAP. SHELL SIZE	A MAX DIA	C MAX	D DIA (+/-0.10)	E (+/-0.15)	AS85049/26-2 CRIMP RING	THREAD UNEF CLASS B
8	0.750 (19.1)	1.140 (28.96)	0.337 (8.56)	0.250 (6.35)	-8	0.4375-28
10	0.850 (21.59)	1.140 (28.96)	0.488 (12.40)	0.325 (8.26)	-10	0.5625-24
12	1.000 (25.40)	1.140 (28.96)	0.500 (12.70)	0.420 (10.67)	-12	0.6875-24
14	1.100 (27.94)	1.140 (28.96)	0.620 (15.75)	0.540 (13.72)	-14	0.8125-20
16	1.250 (31.75)	1.140 (28.96)	0.750 (19.05)	0.670 (17.02)	-16	0.9375-20
18	1.400 (35.56)	1.140 (28.96)	0.880 (22.35)	0.789 (20.04)	-18	1.0625-18
20	1.500 (38.10)	1.140 (28.96)	1.000 (25.40)	0.914 (23.22)	-20	1.1875-18
22	1.650 (41.91)	1.140 (28.96)	1.120 (28.45)	1.039 (26.39)	-22	1.3125-18
24	1.750 (44.45)	1.140 (28.96)	1.192 (30.28)	1.112 (28.24)	-24	1.4375-18

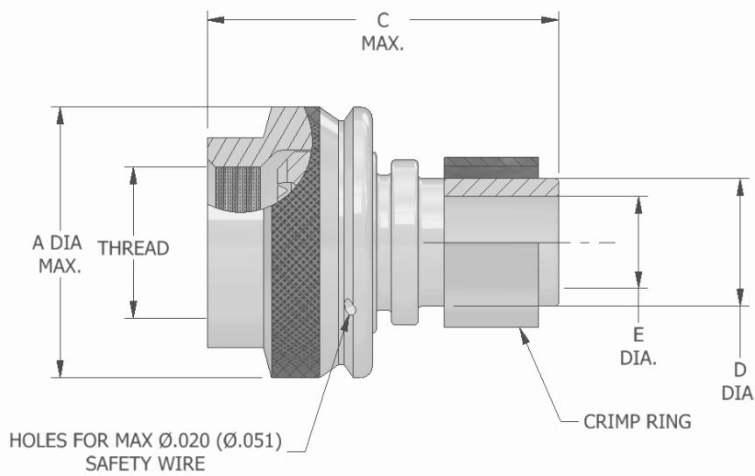

NOTES:

1. METRIC DIMENSIONS (mm) ARE IN PARENTHESES.
2. FOR COMPLETE DIMENSIONS, SEE THE APPLICABLE MILITARY SPECIFICATION.



AS85049/36

BACKSHELL, NONENVIRONMENTAL, STRAIGHT

(FOR MIL-DTL-38999 SERIES I AND II CONNECTORS)

PART NUMBER DEVELOPMENT

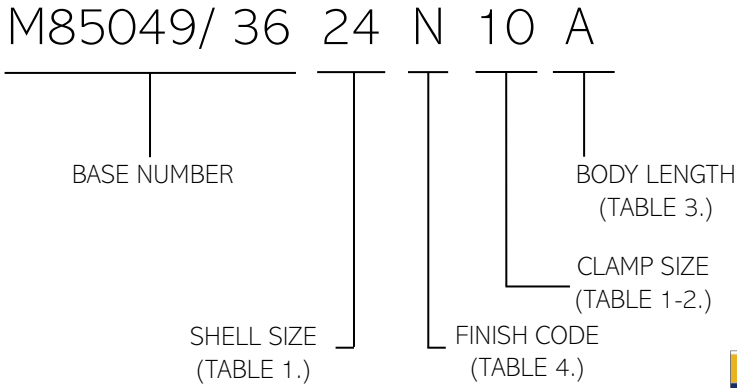

TABLE 1. SHELL SIZE AND CLAMP SIZE			
SHELL SIZE	MIN CLAMP SIZE	MAX CLAMP SIZE	THREAD UNEF-2B
8	01	02	0.4375-28
10	01	03	0.5625-24
12	02	04	0.6875-24
14	02	05	0.8125-20
16	02	06	0.9375-20
18	03	07	1.0625-18
20	03	08	1.1875-18
22	03	09	1.3125-18
24	04	10	1.4375-18

TABLE 2. CLAMP SIZE AND DIMENSIONS			
CLAMP SIZE	CABLE RANGE MIN	CABLE RANGE MAX	Y DIM MAX
1	.062 (1.57)	.125 (3.18)	.781 (19.84)
2	.125 (3.18)	.250 (6.35)	.969 (24.61)
3	.250 (6.35)	.375 (9.53)	1.062 (26.97)
4	.312 (7.92)	.500 (12.70)	1.156 (29.36)
5	.437 (11.10)	.625 (15.88)	1.250 (31.75)
6	.562 (14.27)	.750 (19.05)	1.375 (34.92)
7	.687 (17.45)	.875 (22.22)	1.500 (38.10)
8	.812 (20.62)	1.000 (25.40)	1.625 (41.28)
9	.937 (23.80)	1.125 (28.58)	1.750 (44.45)
10	1.062 (26.97)	1.250 (31.75)	1.875 (47.62)

TABLE 3. ACCESSORY BODY LENGTH	
CODE	LENGTH ±.032 (.810)
STANDARD	1.500 (38.1)
A	2.500 (63.5)
B	3.500 (88.9)
C	4.500 (114.3)

TABLE 4. PLATING CODE	
CODE	DESCRIPTION
N	ELECTROLESS NICKEL
W	CADMIUM, OLIVE DRAB
X	NICKEL FLUOROCARBON POLYMER
Z	ZINC NICKEL

OMIT FOR STANDARD.

ALUMINUM ALLOY IN ACCORDANCE WITH AS85049.

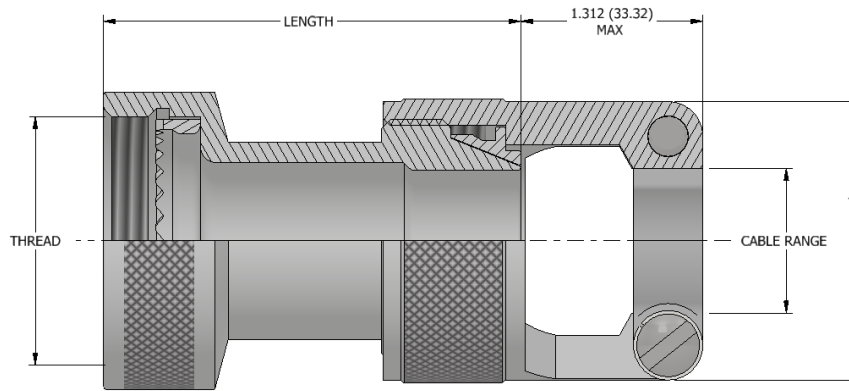

NOTES:

1. METRIC DIMENSIONS (mm) ARE IN PARENTHESES.
2. FOR COMPLETE DIMENSIONS, SEE THE APPLICABLE MILITARY SPECIFICATION.
3. "CABLE RANGE" INDICATES THE ACCEPTABLE SIZE RANGE FOR THE CABLE OR WIRE BUNDLE. THE DIMENSIONS PROVIDED ARE NOT INTENDED FOR INSPECTION USE.



AS85049/49

STRAIN RELIEF, STRAIGHT, SELF-LOCKING

(FOR MIL-DTL-38999 SERIES I AND II CONNECTORS)

PART NUMBER DEVELOPMENT

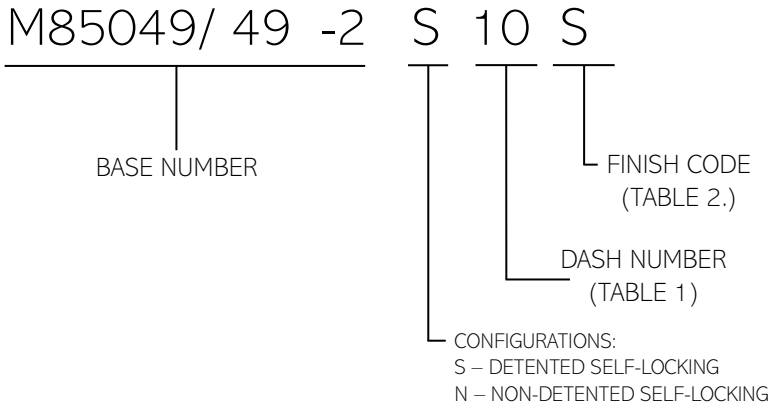
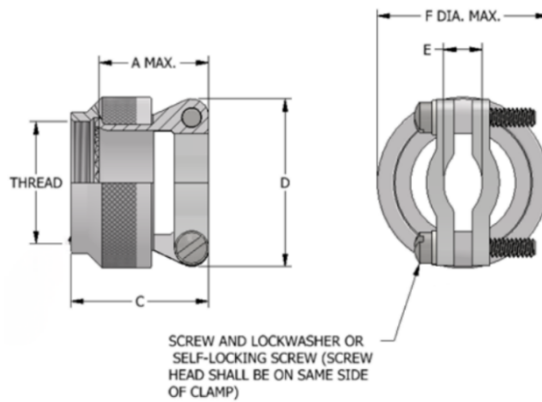

TABLE 2. PLATING CODE	
CODE	DESCRIPTION
A	BLACK ANODIZE, CLASS 2 (1)
N	ELECTROLESS NICKEL (1)
W	CADMIUM, OLIVE DRAB (1)
S	PASSIVATE (2)

(1) ALUMINUM ALLOY IN ACCORDANCE WITH AS85049.
(2) CORROSION RESISTANT STEEL 300 SERIES IN ACCORDANCE WITH AS85049.

TABLE 1. SHELL SIZES AND DIMENSIONS									
DASH NUMBER	CONNECTOR SHELL SIZE SERIES II	CONNECTOR SHELL SIZE SERIES I	A MAX.	C MAX.	D MAX.	E MIN.	E MAX.	F MAX DIA.	THREAD UNEF-2B
8	8	9	.910 (23.1)	1.150 (29.2)	.850 (21.6)	.098 (2.49)	.234 (5.94)	.859 (21.82)	7/16-28
10	10	11	.910 (23.1)	1.150 (29.2)	.900 (22.9)	.153 (3.89)	.234 (5.94)	.984 (24.99)	9/16-24
12	12	13	1.010 (25.7)	1.250 (31.8)	1.100 (27.9)	.190 (4.83)	.328 (8.33)	1.156 (29.36)	11/16-24
14	14	15	1.060 (26.9)	1.300 (33.0)	1.150 (29.2)	.260 (6.60)	.457 (11.61)	1.281 (32.54)	13/16-20
16	16	17	1.160 (29.5)	1.400 (35.6)	1.300 (33.0)	.283 (7.19)	.614 (15.60)	1.406 (35.71)	15/16-20
18	18	19	1.410 (35.8)	1.650 (41.9)	1.500 (38.1)	.325 (8.26)	.634 (16.10)	1.516 (38.51)	1 1/16-18
20	20	21	1.510 (38.4)	1.750 (44.5)	1.600 (40.6)	.343 (8.71)	.698 (17.73)	1.641 (41.68)	1 3/16-18
22	22	23	1.660 (42.2)	1.900 (48.3)	1.700 (43.2)	.381 (9.68)	.823 (20.90)	1.766 (44.86)	1 5/16-18
24	24	25	1.760 (44.7)	2.000 (50.8)	1.800 (45.7)	.418 (10.62)	.853 (21.67)	1.891 (48.03)	1 7/16-18



NOTES:

1. METRIC DIMENSIONS (mm) ARE IN PARENTHESES.
2. FOR COMPLETE DIMENSIONS, SEE THE APPLICABLE MILITARY SPECIFICATION.
3. "CABLE RANGE" INDICATES THE ACCEPTABLE SIZE RANGE FOR THE CABLE OR WIRE BUNDLE. THE DIMENSIONS PROVIDED ARE NOT INTENDED FOR INSPECTION USE.



AS85049/49

STRAIN RELIEF, STRAIGHT, NON-SELF-LOCKING

(FOR MIL-DTL-38999 SERIES I AND II CONNECTORS)

PART NUMBER DEVELOPMENT

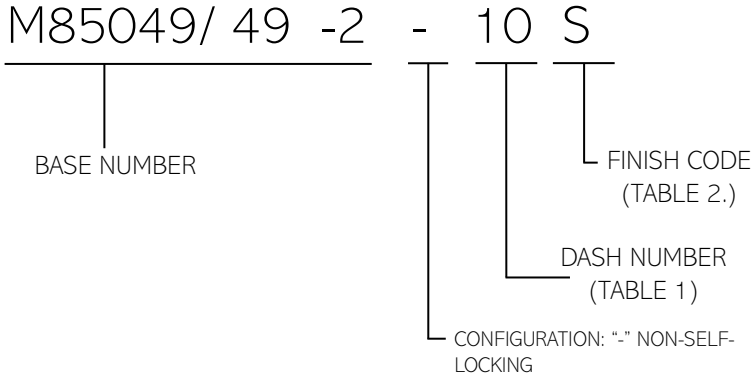
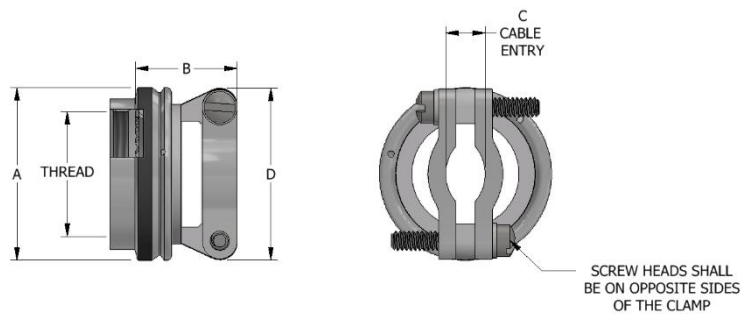

TABLE 2. PLATING CODE	
CODE	DESCRIPTION
A	BLACK ANODIZE, CLASS 2 (1)
N	ELECTROLESS NICKEL (1)
W	CADMIUM, OLIVE DRAB (1)
S	PASSIVATE (2)

(1) ALUMINUM ALLOY IN ACCORDANCE WITH AS85049.
 (2) CORROSION RESISTANT STEEL 300 SERIES IN ACCORDANCE WITH AS85049.

TABLE 1. SHELL SIZES AND DIMENSIONS								
DASH NUMBER	CONNECTOR SHELL SIZE SERIES II	CONNECTOR SHELL SIZE SERIES I	A MAX	B MAX	C MIN.	C MAX.	D MAX.	THREAD
8	8	9	.75 (19.1)	.91 (23.1)	.098 (2.49)	.234 (5.94)	.85 (21.6)	7/16-28
10	10	11	.85 (21.6)	.91 (23.1)	.153 (3.89)	.234 (5.94)	.90 (22.9)	9/16-24
12	12	13	1.00 (25.4)	1.01 (25.7)	.190 (4.83)	.328 (8.33)	1.10 (27.9)	11/16-24
14	14	15	1.10 (27.9)	1.06 (26.9)	.260 (6.60)	.457 (11.61)	1.15 (29.2)	13/16-20
16	16	17	1.25 (31.8)	1.16 (29.5)	.283 (7.19)	.614 (15.60)	1.30 (33.0)	15/16-20
18	18	19	1.40 (35.6)	1.41 (35.8)	.325 (8.26)	.634 (16.10)	1.50 (38.1)	1 1/16-18
20	20	21	1.50 (38.1)	1.51 (38.4)	.343 (8.71)	.698 (17.73)	1.60 (40.6)	1 3/16-18
22	22	23	1.65 (41.9)	1.66 (42.2)	.381 (9.68)	.823 (20.90)	1.70 (43.2)	1 5/16-18
24	24	25	1.75 (44.5)	1.76 (44.7)	.418 (10.62)	.853 (21.67)	1.80 (45.7)	1 7/16-18



NOTES:

1. METRIC DIMENSIONS (mm) ARE IN PARENTHESES.
2. FOR COMPLETE DIMENSIONS, SEE THE APPLICABLE MILITARY SPECIFICATION.
3. "CABLE RANGE" INDICATES THE ACCEPTABLE SIZE RANGE FOR THE CABLE OR WIRE BUNDLE. THE DIMENSIONS PROVIDED ARE NOT INTENDED FOR INSPECTION USE.



AS85049/52

STRAIN RELIEF, NONENVIRONMENTAL, SELF-LOCKING AND NON-SELF-LOCKING, STRAIGHT (FOR AS50151 CRIMP, AS95234, MIL-DTL-26482 SERIES 2, AS81703 SERIES 3, AND MIL-DTL-83723 SERIES III CONNECTORS)

PART NUMBER DEVELOPMENT

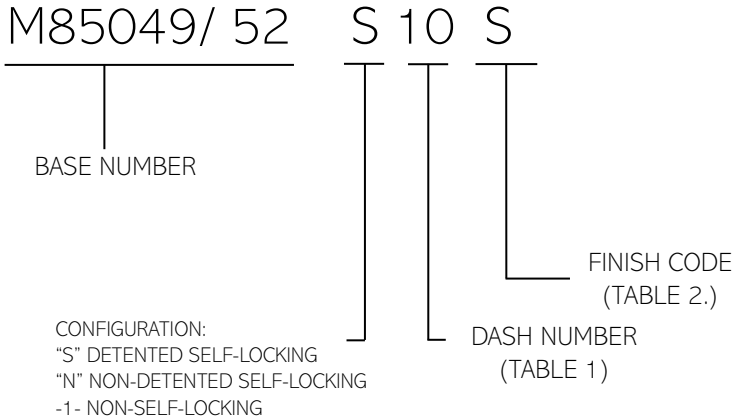

TABLE 2. PLATING CODE	
CODE	DESCRIPTION
A	BLACK ANODIZE, CLASS 2 (1)
N	ELECTROLESS NICKEL (1)
W	CADMIUM, OLIVE DRAB (1)
S	PASSIVATE (2)

(1) ALUMINUM ALLOY IN ACCORDANCE WITH AS85049.
(2) CORROSION RESISTANT STEEL IN ACCORDANCE WITH AS85049.

TABLE 1. DIMENSIONS

DASH NUMBER	A MAX	B MAX	C MIN	C MAX	D MAX	THREAD CLASS 2B
-3 1/	-	-	.125 (3.18)	.204 (5.18)	.782 (19.86)	.563 – 24 UNEF
-8	.885 (22.48)	.73 (18.54)	.125 (3.18)	.204 (5.18)	.782 (19.86)	.500 – 20 UNF
-10	1.010 (25.65)	.85 (21.59)	.187 (4.75)	.286 (7.26)	.862 (21.89)	.625 – 24 UNEF
-12	1.135 (28.83)	.98 (24.89)	.291 (7.39)	.416 (10.57)	1.003 (25.48)	.750 – 20 UNEF
-14	1.260 (32.00)	.98 (24.89)	.351 (8.92)	.476 (12.09)	1.061 (26.95)	.875 – 20 UNEF
-16	1.385 (35.18)	1.10 (27.94)	.501 (12.73)	.625 (15.88)	1.334 (33.88)	1.000 – 20 UNEF
-18	1.510 (38.35)	1.35 (34.29)	.518 (13.16)	.706 (17.93)	1.466 (37.24)	1.063 – 18 UNEF
-20	1.635 (41.53)	1.48 (37.59)	.581 (14.76)	.831 (21.11)	1.572 (39.93)	1.188 – 18 UNEF
-22	1.760 (44.70)	1.60 (40.64)	.644 (16.36)	.956 (24.28)	1.688 (42.88)	1.313 – 18 UNEF
-24	1.885 (47.88)	1.73 (43.94)	.706 (17.93)	1.081 (27.46)	1.790 (45.47)	1.438 – 18 UNEF
-28	2.135 (54.23)	1.88 (47.75)	.750 (19.05)	1.187 (30.15)	2.035 (51.69)	1.750 – 18 UNS
-32	2.395 (60.83)	2.13 (54.10)	.875 (22.23)	1.250 (31.75)	2.386 (60.60)	2.000 – 18 UNS
-36	2.635 (66.93)	2.44 (61.98)	.938 (23.83)	1.375 (34.93)	2.496 (63.40)	2.250 – 16 UN
-40	2.885 (73.28)	2.63 (66.80)	.938 (23.83)	1.500 (38.10)	2.566 (65.18)	2.500 – 16 UN
-44	3.135 (79.63)	3.00 (76.20)	1.188 (30.18)	1.750 (44.45)	2.860 (72.64)	2.750 – 16 UN
-48	3.385 (85.98)	3.40 (86.36)	1.312 (33.32)	1.875 (47.63)	3.344 (84.94)	3.000 – 16 UN
-61 1/	-	-	.706 (17.93)	1.081 (27.46)	1.775 (45.09)	1.500 – 18 UNEF

1/ NOT AVAILABLE ON SELF-LOCKING CONFIGURATION.

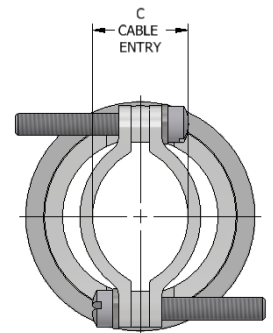
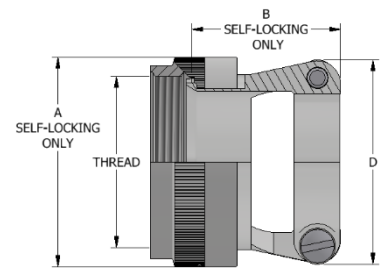

NOTES:

- 1.METRIC DIMENSIONS (mm) ARE IN PARENTHESSES.
- 2.FOR COMPLETE DIMENSIONS, SEE THE APPLICABLE MILITARY SPECIFICATION.
- 3."CABLE RANGE" INDICATES THE ACCEPTABLE SIZE RANGE FOR THE CABLE OR WIRE BUNDLE. THE DIMENSIONS PROVIDED ARE NOT INTENDED FOR INSPECTION USE.



AS85049/60 ADAPTER, SHRINK BOOT

(FOR AS50151 CRIMP, AS95234, MIL-DTL-26482 SERIES 2, AS81703 SERIES 3, AND MIL-DTL-83723 SERIES III CONNECTORS)

PART NUMBER DEVELOPMENT

M85049/ 60 - 1 Y 10

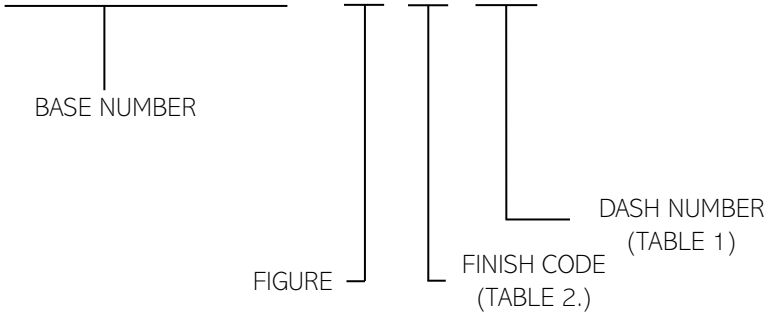

CODE	DESCRIPTION
A	BLACK ANODIZE, CLASS 2
N	ELECTROLESS NICKEL
W	CADMIUM, OLIVE DRAB
X	NICKEL FLUOROCARBON POLYMER
Y	PURE DENSE ELECTRODEPOSITED
Z	ZINC NICKEL

ALUMINUM ALLOY IN ACCORDANCE WITH AS85049.

DASH NO	A DIA. +.000-.045 (1.14)	B MIN DIA	C DIA. +.000-.020 (0.51)	D MAX	THREAD CLASS 2B
3	.669 (17.0)	.250 (6.4)	.533 (13.5)	.832 (21.1)	0.5625-24 UNEF
8	.617 (15.7)	.250 (6.4)	.533 (13.5)	.832 (21.1)	0.500-20 UNF
10	.734 (18.6)	.355 (9.0)	.605 (15.4)	.832 (21.1)	0.625-24 UNEF
12	.858 (21.8)	.491 (12.5)	.774 (19.7)	.832 (21.1)	0.750-20 UNEF
14	.984 (25.0)	.565 (14.4)	.838 (21.3)	.832 (21.1)	0.875-20 UNEF
16	1.112 (28.2)	.690 (17.5)	.963 (24.5)	.832 (21.1)	1.000-20 UNEF
18	1.218 (30.9)	.769 (19.5)	1.042 (26.5)	.832 (21.1)	1.0625-18 UNEF
20	1.345 (34.2)	.894 (22.7)	1.217 (30.9)	.832 (21.1)	1.1875-18 UNEF
22	1.468 (37.3)	1.019 (25.9)	1.355 (34.4)	.832 (21.1)	1.3125-18 UNEF
24	1.593 (40.5)	1.134 (28.8)	1.443 (36.7)	.832 (21.1)	1.4375-18 UNEF
28	1.969 (50.0)	1.369 (34.8)	1.709 (43.4)	.994 (25.2)	1.750-18 UNS
32	2.219 (56.4)	1.615 (41.0)	1.919 (48.7)	.994 (25.2)	2.000-18 UNS
36	2.469 (62.7)	1.830 (46.5)	2.169 (55.1)	.994 (25.2)	2.250-16 UN
40	2.719 (69.1)	2.045 (51.9)	2.402 (61.0)	.994 (25.2)	2.500-16 UN
44	2.969 (75.4)	2.300 (58.4)	2.657 (67.5)	.994 (25.2)	2.750-16 UN
48	3.219 (81.8)	2.550 (64.8)	2.907 (73.8)	.994 (25.2)	3.000-16 UN
61	1.653 (42.0)	1.174 (29.8)	1.529 (38.8)	.832 (21.1)	1.500-18 UNEF

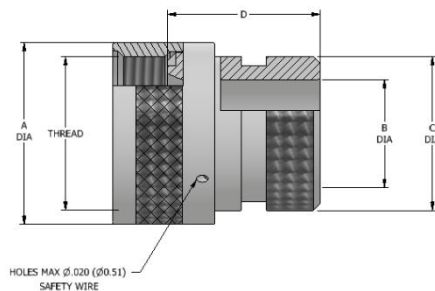

NOTES:

1. METRIC DIMENSIONS (mm) ARE IN PARENTHESES.
2. FOR COMPLETE DIMENSIONS, SEE THE APPLICABLE MILITARY SPECIFICATION.



AS85049/60 ADAPTER, SHRINK BOOT

(FOR AS50151 CRIMP, AS95234, MIL-DTL-26482 SERIES 2, AS81703 SERIES 3, AND MIL-DTL-83723 SERIES III CONNECTORS)

PART NUMBER DEVELOPMENT

M85049/ 60 - 2 G 10 Y

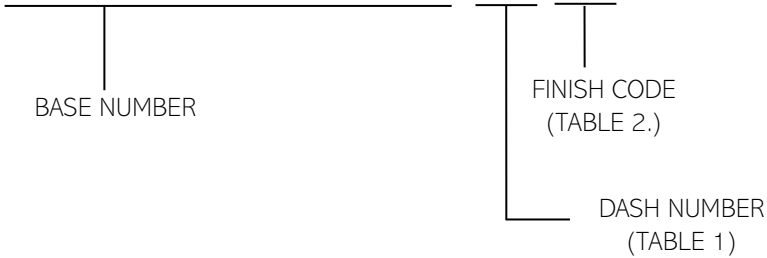

CODE	DESCRIPTION
A	BLACK ANODIZE, CLASS 2
N	ELECTROLESS NICKEL
W	CADMIUM, OLIVE DRAB
X	NICKEL FLUOROCARBON POLYMER
Y	PURE DENSE ELECTRODEPOSITED
Z	ZINC NICKEL

ALUMINUM ALLOY IN ACCORDANCE WITH AS85049.

DASH NO.	A DIA +0.000 - .045 (1.14)	B DIA +0.000 - .020 (0.51)	C MAX	THREAD CLASS 2B
3	.750 (19.1)	.709 (18.0)	.540 (13.7)	0.5625-24 UNEF
8	.688 (17.5)	.657 (16.7)	.540 (13.7)	0.500-20 UNF
10	.803 (20.4)	.774 (19.7)	.540 (13.7)	0.625-24 UNEF
12	.938 (23.8)	.898 (22.8)	.540 (13.7)	0.750-20 UNF
14	1.063 (27.0)	1.024 (26.0)	.540 (13.7)	0.875-20 UNEF
16	1.238 (31.4)	1.152 (29.3)	.540 (13.7)	1.000-20 UNEF
18	1.310 (33.3)	1.243 (31.6)	.540 (13.7)	1.0625-18 UNEF
20	1.436 (36.5)	1.370 (34.8)	.540 (13.7)	1.1875-18 UNEF
22	1.560 (39.6)	1.443 (36.7)	.540 (13.7)	1.3125-18 UNEF
24	1.686 (42.8)	1.618 (41.1)	.540 (13.7)	1.4375-18 UNEF
28	2.062 (52.4)	1.969 (50.0)	.702 (17.8)	1.750-18 UNS
32	2.312 (58.7)	2.219 (56.4)	.702 (17.8)	2.000-18 UNS
36	2.562 (65.1)	2.469 (62.7)	.702 (17.8)	2.250-16 UN
40	2.812 (71.4)	2.719 (69.1)	.702 (17.8)	2.500-16 UN
44	3.062 (77.8)	2.969 (75.4)	.702 (17.8)	2.750-16 UN
48	3.312 (84.1)	3.219 (81.8)	.702 (17.8)	3.000-16 UN
61	1.748 (44.4)	1.653 (42.0)	.540 (13.7)	1.500-18 UNEF

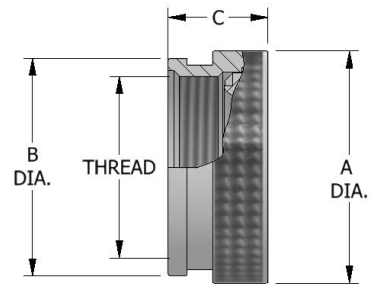

NOTES:

1. METRIC DIMENSIONS (mm) ARE IN PARENTHESES.
2. FOR COMPLETE DIMENSIONS, SEE THE APPLICABLE MILITARY SPECIFICATION.



AS85049/62

ADAPTER, SHRINK BOOT

(FOR MIL-DTL-38999 SERIES I AND II CONNECTORS)

PART NUMBER DEVELOPMENT

M85049/ 62 - 10 Y D

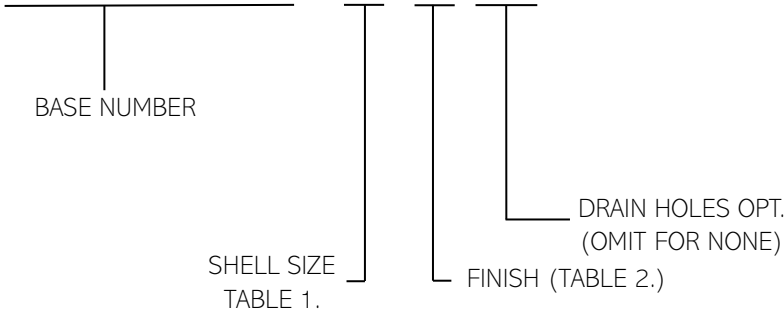
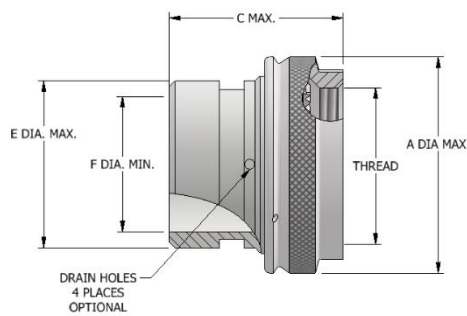

TABLE 2. PLATING CODE	
CODE	DESCRIPTION
A	BLACK ANODIZE, CLASS 2
N	ELECTROLESS NICKEL
W	CADMIUM, OLIVE DRAB
X	NICKEL FLUOROCARBON POLYMER
Y	PURE DENSE ELECTRODEPOSITED
Z	ZINC NICKEL

ALUMINUM ALLOY IN ACCORDANCE WITH AS85049.

TABLE 1. SHELL SIZE AND DIMENSIONS					
DASH NUMBER	A DIAMETER MAXIMUM	C MAXIMUM	E DIAMETER MAXIMUM	F MINIMUM	THREAD CLASS 2B
8	.75 (19.05)	1.000 (25.40)	.533 (13.54)	.250 (6.35)	.438-28 UNEF
10	.85 (21.59)	1.000 (25.40)	.605 (15.37)	.375 (9.53)	.563-24 UNEF
12	1.00 (25.40)	1.000 (25.40)	.774 (19.66)	.500 (12.70)	.688-24 UNEF
14	1.10 (27.94)	1.000 (25.40)	.838 (21.29)	.625 (15.88)	.813-20 UNEF
16	1.25 (31.75)	1.000 (25.40)	.963 (24.46)	.750 (19.05)	.938-20 UNEF
18	1.40 (35.56)	1.000 (25.40)	1.042 (26.47)	.812 (20.62)	1.063-18 UNEF
20	1.50 (38.10)	1.000 (25.40)	1.217 (30.91)	.937 (23.80)	1.188-18 UNEF
22	1.65 (41.91)	1.000 (25.40)	1.355 (34.42)	1.062 (26.97)	1.313-18 UNEF
24	1.75 (44.45)	1.000 (25.40)	1.443 (36.65)	1.188 (30.18)	1.438-18 UNEF



NOTES:

- 1.METRIC DIMENSIONS (mm) ARE IN PARENTHESES.
- 2.FOR COMPLETE DIMENSIONS, SEE THE APPLICABLE MILITARY SPECIFICATION.



AS85049/69

ADAPTER, SHRINK BOOT

(FOR MIL-DTL-38999 SERIES III AND IV CONNECTORS)

PART NUMBER DEVELOPMENT

M85049/ 69 - 11 Y D

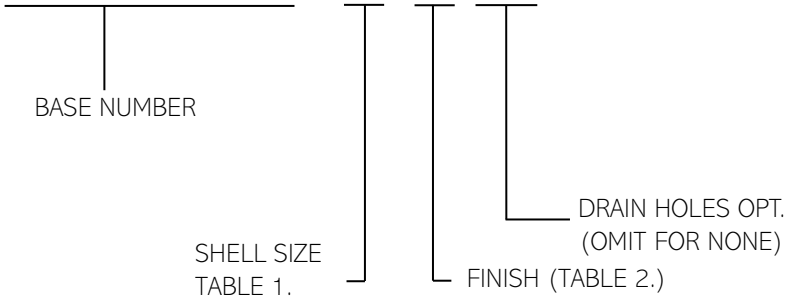
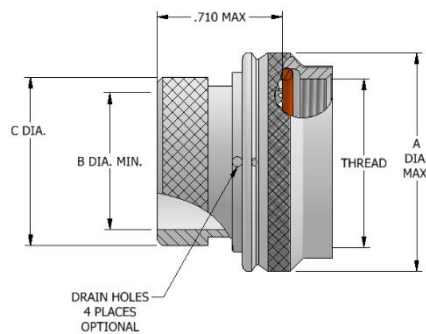

TABLE 2. PLATING CODE	
CODE	DESCRIPTION
A	BLACK ANODIZE, CLASS 2
N	ELECTROLESS NICKEL
W	CADMIUM, OLIVE DRAB
X	NICKEL FLUOROCARBON POLYMER
Y	PURE DENSE ELECTRODEPOSITED
Z	ZINC NICKEL

ALUMINUM ALLOY IN ACCORDANCE WITH AS85049.

TABLE 1. SHELL SIZE AND DIMENSIONS				
SHELL SIZE	A DIA MAX	B DIA MIN	C DIA MAX	THREAD
9	.75 (19.1)	.250 (6.35)	.533 (13.54)	M12X1.0-6H
11	.85 (21.6)	.375 (9.52)	.605 (15.37)	M15X1.0-6H
13	1.00 (25.4)	.500 (12.70)	.774 (19.66)	M18X1.0-6H
15	1.15 (29.2)	.625 (15.88)	.838 (21.29)	M22X1.0-6H
17	1.25 (31.8)	.750 (19.05)	.963 (24.46)	M25X1.0-6H
19	1.40 (35.6)	.812 (20.62)	1.042 (26.47)	M28X1.0-6H
21	1.55 (39.4)	.937 (23.80)	1.217 (30.91)	M31X1.0-6H
23	1.65 (41.9)	1.062 (26.97)	1.355 (34.42)	M34X1.0-6H
25	1.85 (47.0)	1.188 (30.18)	1.443 (36.65)	M37X1.0-6H



NOTES:

1. METRIC DIMENSIONS (mm) ARE IN PARENTHESES.
2. FOR COMPLETE DIMENSIONS, SEE THE APPLICABLE MILITARY SPECIFICATION.



AS85049/82

BACKSHELL, STRAIGHT, SELF-LOCKING, SHIELD BAND TERMINATION (RFI/EMI)

(FOR AS50151 CRIMP, AS95234, MIL-DTL-26482 SERIES 2, AS81703 SERIES 3, AND MIL-DTL-83723 SERIES III CONNECTORS)

PART NUMBER DEVELOPMENT

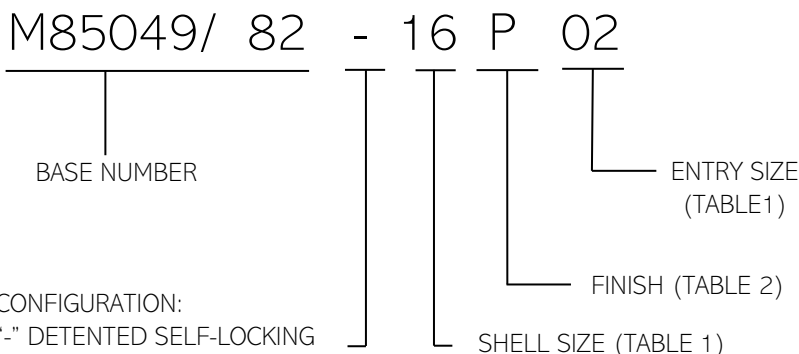

CONFIGURATION:
 "-" DETENTED SELF-LOCKING
 "N" NON-DETENTED SELF-LOCKING

CODE	DESCRIPTION
N	ELECTROLESS NICKEL
P	CADMIUM OLIVE DRAB OVER ELECTROLESS NICKEL (SELECTIVE PLATING)
YP	PURE DENSE ELECTRODEPOSITED ALUMINUM OVER ELECTROLESS NICKEL (SELECTIVE PLATING)
W	CADMIUM OLIVE DRAB
X	NICKEL FLUOROCARBON POLYMER
Z	ZINC NICKEL
ZP	ZINC NICKEL OVER ELECTROLESS NICKEL (SELECTIVE PLATING)

ALUMINUM ALLOY IN ACCORDANCE WITH AS85049.

TABLE 1. SHELL SIZE AND DIMENSIONS				
SHELL SIZE	A MAX DIA	B DIA ±.010 ENTRY SIZE 02	B DIA ±.010 ENTRY SIZE 03	THREAD CLASS 2B
8	.885 (22.48)	N/A	.250 (6.35)	.500-20 UNF
10	1.010 (25.65)	N/A	.312 (7.92)	.625-24 UNEF
12	1.135 (28.83)	.312 (7.92)	.438 (11.13)	.750-20 UNEF
14	1.260 (32.00)	.438 (11.13)	.562 (14.27)	.875-20 UNEF
16	1.385 (35.18)	.500 (12.70)	.625 (15.88)	1.000-20UNEF
18	1.510 (38.35)	.625 (15.88)	.750 (19.05)	1.062-18 UNEF
20	1.635 (41.53)	.625 (15.88)	.812 (20.62)	1.188-18 UNEF
22	1.760 (44.70)	.688 (17.48)	.938 (23.83)	1.313-18 UNEF
24	1.885 (47.88)	.750 (19.05)	1.000 (25.40)	1.438-18 UNEF
28	2.135 (54.23)	.875 (22.23)	1.125 (28.58)	1.750-18 UNS
61	1.95 (49.53)	.750 (19.05)	1.000 (25.40)	1.500-18 UNEF

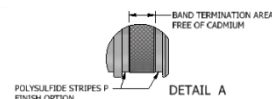
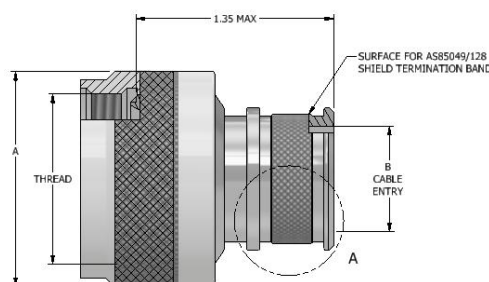

NOTES:

1. METRIC DIMENSIONS (mm) ARE IN PARENTHESES.
2. FOR COMPLETE DIMENSIONS, SEE THE APPLICABLE MILITARY SPECIFICATION.
3. FOR USE WITH AS85049/128 BANDS.



AS85049/83

BACKSHELL, 45°, SELF-LOCKING, SHIELD BAND TERMINATION (RFI/EMI)

(FOR AS50151 CRIMP, AS95234, MIL-DTL-26482 SERIES 2, AS81703 SERIES 3, AND MIL-DTL-83723 SERIES III CONNECTORS)

PART NUMBER DEVELOPMENT

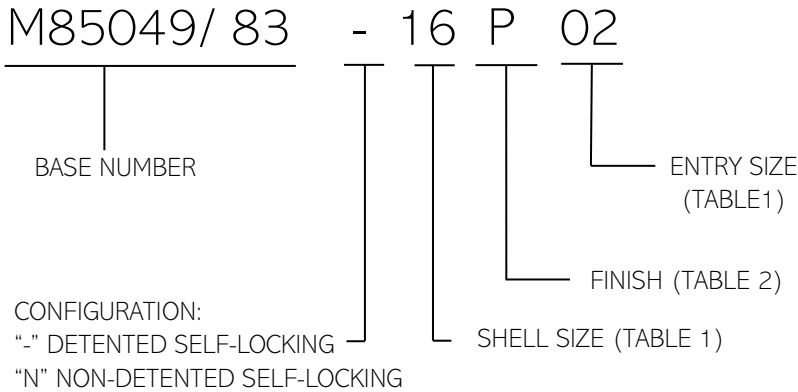
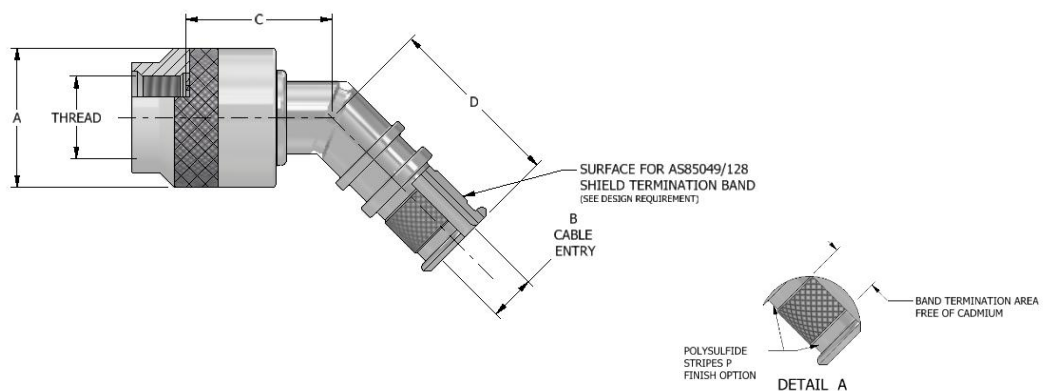

TABLE 2. PLATING CODE	
CODE	DESCRIPTION
N	ELECTROLESS NICKEL
P	CADMIUM OLIVE DRAB OVER ELECTROLESS NICKEL (SELECTIVE PLATING)
YP	PURE DENSE ELECTRODEPOSITED ALUMINUM OVER ELECTROLESS NICKEL (SELECTIVE PLATING)
W	CADMIUM OLIVE DRAB
X	NICKEL FLUOROCARBON POLYMER
Z	ZINC NICKEL
ZP	ZINC NICKEL OVER ELECTROLESS NICKEL (SELECTIVE PLATING)

ALUMINUM ALLOY IN ACCORDANCE WITH AS85049.

TABLE 1. SHELL SIZE AND DIMENSIONS						
SHELL SIZE	A MAX DIA	B DIA ±.010 (0.25) ENTRY SIZE		C MAX DIA	D MAX DIA	THREAD CLASS 2B
		02	03			
8	.885 (22.48)	N/A	.250 (6.35)	.87 (22.10)	1.16 (29.46)	.500-20 UNF
10	1.010 (25.65)	N/A	.312 (7.92)	.89 (22.61)	1.18 (29.97)	.625-24 UNEF
12	1.135 (28.83)	.312 (7.92)	.438 (11.13)	.92 (23.37)	1.20 (30.48)	.750-20 UNEF
14	1.260 (32.00)	.438 (11.13)	.562 (14.27)	.94 (23.88)	1.22 (30.99)	.875-20 UNEF
16	1.385 (35.18)	.500 (12.70)	.625 (15.88)	.96 (24.38)	1.25 (31.75)	1.000-20 UNEF
18	1.510 (38.35)	.625 (15.88)	.750 (19.05)	.98 (24.89)	1.26 (32.00)	1.0625-18 UNEF
20	1.635 (41.53)	.625 (15.88)	.812 (20.62)	1.00 (25.40)	1.29 (32.77)	1.1875-18 UNEF
22	1.760 (44.70)	.688 (17.48)	.938 (23.83)	1.03 (26.16)	1.31 (33.27)	1.3125-18 UNEF
24	1.885 (47.88)	.750 (19.05)	1.000 (25.40)	1.05 (26.67)	1.34 (34.04)	1.4375-18 UNEF
28	2.135 (54.23)	.875 (22.23)	1.125 (28.58)	1.10 (27.94)	1.38 (35.05)	1.750-18 UNS



NOTES:

1. METRIC DIMENSIONS (mm) ARE IN PARENTHESES.
2. FOR COMPLETE DIMENSIONS, SEE THE APPLICABLE MILITARY SPECIFICATION.
3. FOR USE WITH AS85049/128 BANDS.



AS85049/84

BACKSHELL, 90°, SELF-LOCKING, SHIELD BAND TERMINATION (RFI/EMI)

(FOR AS50151 CRIMP, AS95234, MIL-DTL-26482 SERIES 2, AS81703 SERIES 3, AND MIL-DTL-83723 SERIES III CONNECTORS)

PART NUMBER DEVELOPMENT

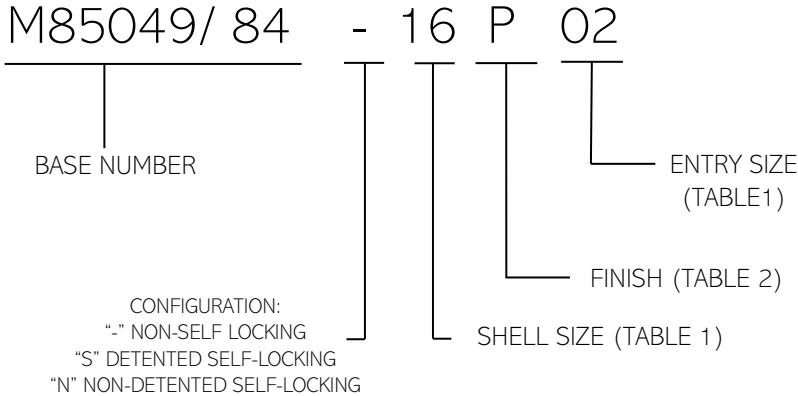
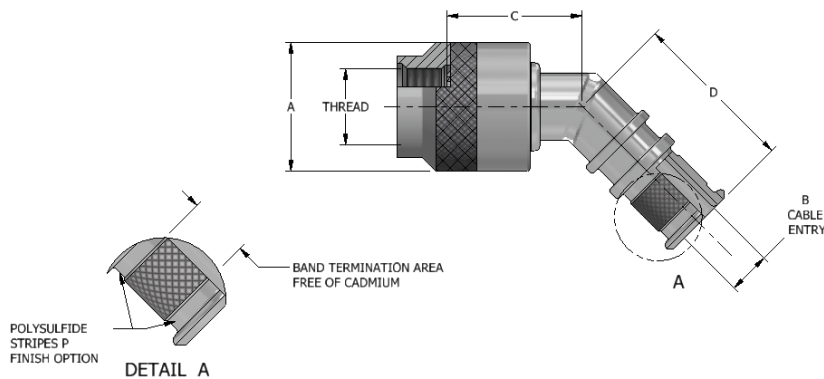

TABLE 2. PLATING CODE	
CODE	DESCRIPTION
N	ELECTROLESS NICKEL
P	CADMIUM OLIVE DRAB OVER ELECTROLESS NICKEL (SELECTIVE PLATING)
YP	PURE DENSE ELECTRODEPOSITED ALUMINUM OVER ELECTROLESS NICKEL (SELECTIVE PLATING)
W	CADMIUM OLIVE DRAB
X	NICKEL FLUOROCARBON POLYMER
Z	ZINC NICKEL
ZP	ZINC NICKEL OVER ELECTROLESS NICKEL (SELECTIVE PLATING)

ALUMINUM ALLOY IN ACCORDANCE WITH AS85049.

TABLE 1. SHELL SIZE AND DIMENSIONS						
SHELL SIZE	A MAX DIA	B DIA ±.010 ENTRY SIZE		C MAX DIA	D MAX DIA	THREAD CLASS 2B
		02	03			
8	.885 (22.48)	N/A	.250 (6.35)	1.188 (30.18)	1.417 (35.99)	.500-20 UNF
10	1.010 (25.65)	N/A	.312 (7.92)	1.281 (32.54)	1.480 (37.59)	.625-24 UNEF
12	1.135 (28.83)	.312 (7.92)	.438 (11.13)	1.406 (35.71)	1.542 (39.17)	.750-20 UNEF
14	1.260 (32.00)	.438 (11.13)	.562 (14.27)	1.531 (38.89)	1.605 (40.77)	.875-20 UNEF
16	1.385 (35.18)	.500 (12.70)	.625 (15.88)	1.656 (42.06)	1.667 (42.34)	1.000-20 UNEF
18	1.510 (38.35)	.625 (15.88)	.750 (19.05)	1.718 (43.64)	1.730 (43.94)	1.0625-18 UNEF
20	1.635 (41.53)	.625 (15.88)	.812 (20.62)	1.844 (46.84)	1.792 (45.52)	1.1875-18 UNEF
22	1.760 (44.70)	.688 (17.48)	.938 (23.83)	1.938 (49.23)	1.850 (46.99)	1.3125-18 UNEF
24	1.885 (47.88)	.750 (19.05)	1.000 (25.40)	2.093 (53.16)	1.917 (48.69)	1.4375-18 UNEF
28	2.135 (54.23)	.875 (22.23)	1.125 (28.58)	2.531 (64.29)	2.042 (51.87)	1.750-18 UNS



NOTES:

- 1.METRIC DIMENSIONS (mm) ARE IN PARENTHESES.
- 2.FOR COMPLETE DIMENSIONS, SEE THE APPLICABLE MILITARY SPECIFICATION.
- 3.FOR USE WITH AS85049/128 BANDS.



AS85049/85

BACKSHELL, STRAIGHT, SELF-LOCKING, SHIELD BAND TERMINATION (RFI/EMI) (FOR MIL-DTL-38999 SERIES I AND II CONNECTORS)

PART NUMBER DEVELOPMENT

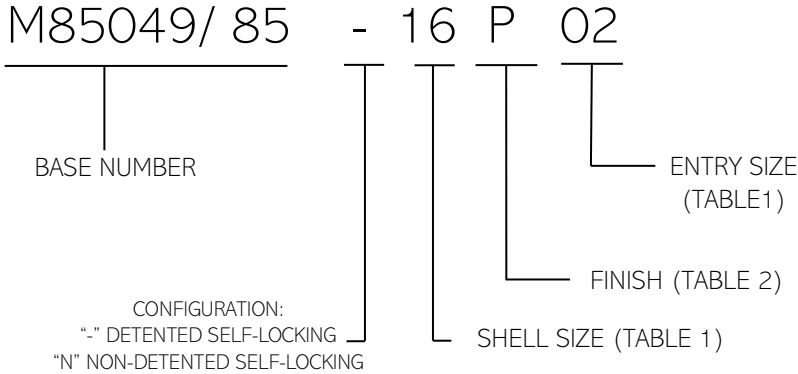
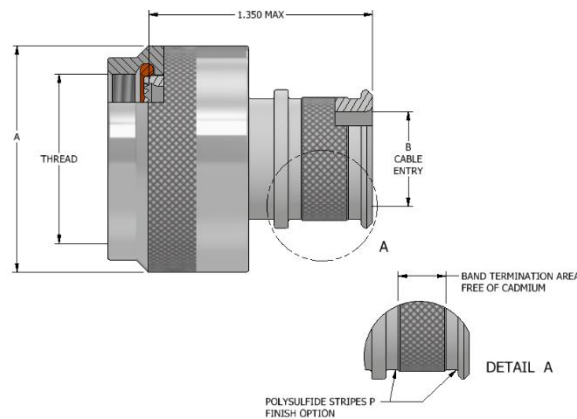

TABLE 2. PLATING CODE	
CODE	DESCRIPTION
N	ELECTROLESS NICKEL
P	CADMIUM OLIVE DRAB OVER ELECTROLESS NICKEL (SELECTIVE PLATING)
YP	PURE DENSE ELECTRODEPOSITED ALUMINUM OVER ELECTROLESS NICKEL (SELECTIVE PLATING)
W	CADMIUM OLIVE DRAB
X	NICKEL FLUOROCARBON POLYMER
Z	ZINC NICKEL
ZP	ZINC NICKEL OVER ELECTROLESS NICKEL (SELECTIVE PLATING)

ALUMINUM ALLOY IN ACCORDANCE WITH AS85049.

TABLE 1. SHELL SIZE AND DIMENSIONS				
SHELL SIZE	A MAX DIA	B DIA ±.010 (.25) ENTRY SIZE		THREAD UNEF-2B
		02	03	
8	.859 (21.82)	N/A	.250 (6.35)	.4375-28
10	.986 (25.04)	N/A	.312 (7.92)	.5625-24
12	1.156 (29.36)	.312 (7.92)	.438 (11.13)	.6875-24
14	1.281 (32.54)	.438 (11.13)	.562 (14.27)	.8125-20
16	1.406 (35.71)	.500 (12.70)	.625 (15.88)	.9375-20
18	1.516 (38.51)	.625 (15.88)	.750 (19.05)	1.0625-18
20	1.641 (41.68)	.625 (15.88)	.812 (20.62)	1.1875-18
22	1.766 (44.86)	.688 (17.48)	.938 (23.83)	1.3125-18
24	1.891 (48.03)	.750 (19.05)	1.000 (25.40)	1.4375-18



NOTES:

1. METRIC DIMENSIONS (mm) ARE IN PARENTHESES.
2. FOR COMPLETE DIMENSIONS, SEE THE APPLICABLE MILITARY SPECIFICATION.
3. FOR USE WITH AS85049/128 BANDS.



AS85049/86

BACKSHELL, 45°, SELF-LOCKING, SHIELD BAND TERMINATION (RFI/EMI) (FOR MIL-DTL-38999 SERIES I AND II CONNECTORS)

PART NUMBER DEVELOPMENT

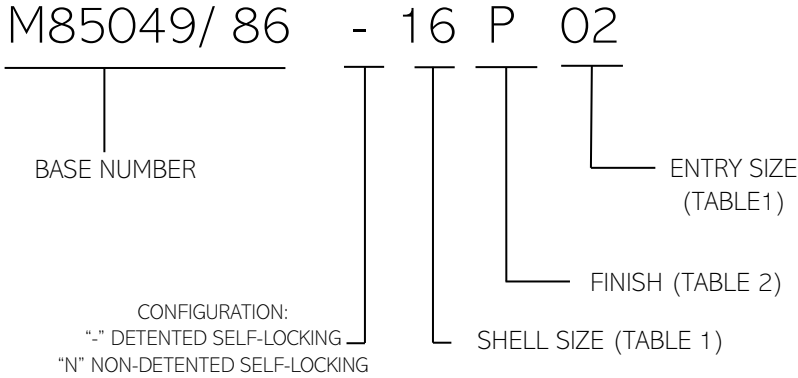
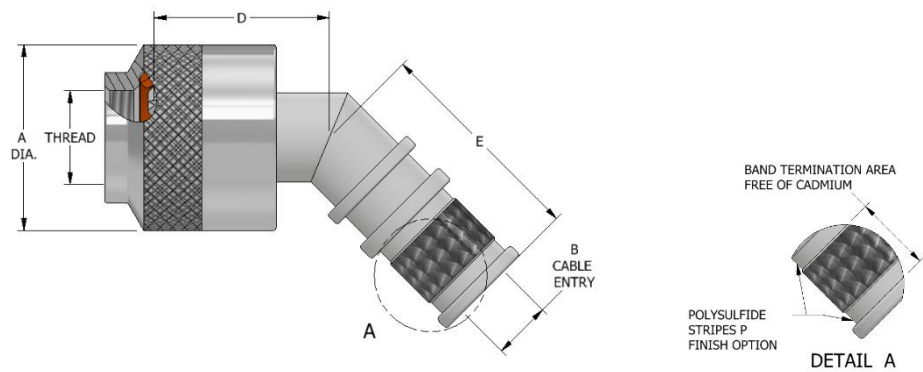

TABLE 2. PLATING CODE	
CODE	DESCRIPTION
N	ELECTROLESS NICKEL
P	CADMIUM OLIVE DRAB OVER ELECTROLESS NICKEL (SELECTIVE PLATING)
YP	PURE DENSE ELECTRODEPOSITED ALUMINUM OVER ELECTROLESS NICKEL (SELECTIVE PLATING)
W	CADMIUM OLIVE DRAB
X	NICKEL FLUOROCARBON POLYMER
Z	ZINC NICKEL
ZP	ZINC NICKEL OVER ELECTROLESS NICKEL (SELECTIVE PLATING)

ALUMINUM ALLOY IN ACCORDANCE WITH AS85049.

TABLE 1. SHELL SIZE AND DIMENSIONS						
SHELL SIZE	A MAX DIA	B DIA ±.010 (.25) ENTRY SIZE		D MAX	E MAX	THREAD UNEF-2B
		02	03			
8	.859 (21.82)	N/A	.250 (6.35)	0.87 (22.10)	1.16 (29.46)	.4375-28
10	.986 (25.04)	N/A	.312 (7.92)	0.90 (22.86)	1.19 (30.23)	.5625-24
12	1.156 (29.36)	.312 (7.92)	.438 (11.13)	0.92 (23.37)	1.21 (30.73)	.6875-24
14	1.281 (32.54)	.438 (11.13)	.562 (14.27)	0.95 (24.13)	1.24 (31.50)	.8125-20
16	1.406 (35.71)	.500 (12.70)	.625 (15.88)	0.98 (24.89)	1.26 (32.00)	.9375-20
18	1.516 (38.51)	.625 (15.88)	.750 (19.05)	0.98 (24.89)	1.27 (32.26)	1.0625-18
20	1.641 (41.68)	.625 (15.88)	.812 (20.62)	1.01 (25.65)	1.30 (33.02)	1.1875-18
22	1.766 (44.86)	.688 (17.48)	.938 (23.83)	1.04 (26.42)	1.33 (33.78)	1.3125-18
24	1.891 (48.03)	.750 (19.05)	1.000 (25.40)	1.07 (27.18)	1.35 (34.29)	1.4375-18



NOTES:

- 1.METRIC DIMENSIONS (mm) ARE IN PARENTHESES.
- 2.FOR COMPLETE DIMENSIONS, SEE THE APPLICABLE MILITARY SPECIFICATION.
- 3.FOR USE WITH AS85049/128 BANDS.



AS85049/87

BACKSHELL, 90°, SELF-LOCKING, SHIELD BAND TERMINATION (RFI/EMI) (FOR MIL-DTL-38999 SERIES I AND II CONNECTORS)

PART NUMBER DEVELOPMENT

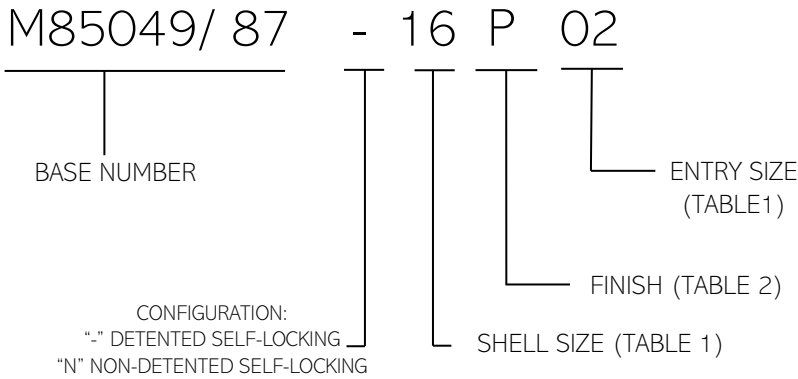

CODE	DESCRIPTION
N	ELECTROLESS NICKEL
P	CADMIUM OLIVE DRAB OVER ELECTROLESS NICKEL (SELECTIVE PLATING)
YP	PURE DENSE ELECTRODEPOSITED ALUMINUM OVER ELECTROLESS NICKEL (SELECTIVE PLATING)
W	CADMIUM OLIVE DRAB
X	NICKEL FLUOROCARBON POLYMER
Z	ZINC NICKEL
ZP	ZINC NICKEL OVER ELECTROLESS NICKEL (SELECTIVE PLATING)

ALUMINUM ALLOY IN ACCORDANCE WITH AS85049.

SHELL SIZE	A MAX DIA	B DIA ±.010 (.25) ENTRY SIZE		D MAX DIM	E MAX DIM	THREAD UNEF-2B
		02	03			
8	.858 (21.8)	N/A	.250 (6.4)	1.375 (34.9)	1.417 (36.0)	.4375-28
10	.984 (25.0)	N/A	.312 (7.9)	1.437 (36.5)	1.480 (37.6)	.5625-24
12	1.157 (29.4)	.312 (7.9)	.438 (11.1)	1.562 (39.7)	1.553 (39.4)	.6875-24
14	1.279 (32.5)	.438 (11.1)	.562 (14.3)	1.687 (42.8)	1.614 (41.0)	.8125-20
16	1.406 (35.7)	.500 (12.7)	.625 (15.9)	1.750 (44.5)	1.678 (42.6)	.9375-20
18	1.516 (38.5)	.625 (15.9)	.750 (19.1)	1.875 (47.6)	1.733 (44.0)	1.0625-18
20	1.642 (41.7)	.625 (15.9)	.812 (20.6)	1.938 (49.2)	1.796 (45.6)	1.1875-18
22	1.768 (44.9)	.688 (17.5)	.938 (23.8)	2.062 (52.4)	1.859 (47.2)	1.3125-18
24	1.889 (48.0)	.750 (19.1)	1.000 (25.4)	2.125 (54.0)	1.919 (48.7)	1.4375-18

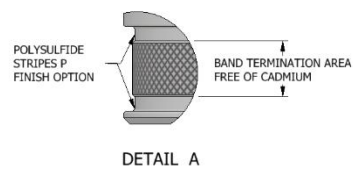
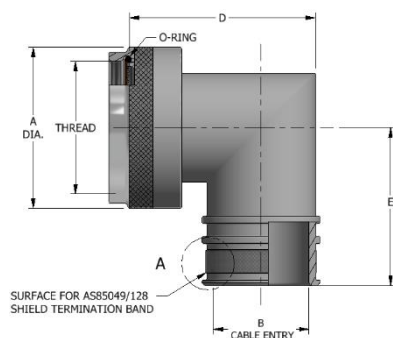

NOTES:

1. METRIC DIMENSIONS (mm) ARE IN PARENTHESES.
2. FOR COMPLETE DIMENSIONS, SEE THE APPLICABLE MILITARY SPECIFICATION.
3. FOR USE WITH AS85049/128 BANDS.



AS85049/88

BACKSHELL, STRAIGHT, SELF-LOCKING, SHIELD BAND TERMINATION (RFI/EMI)

(FOR MIL-DTL-38999 SERIES III AND IV CONNECTORS)

PART NUMBER DEVELOPMENT

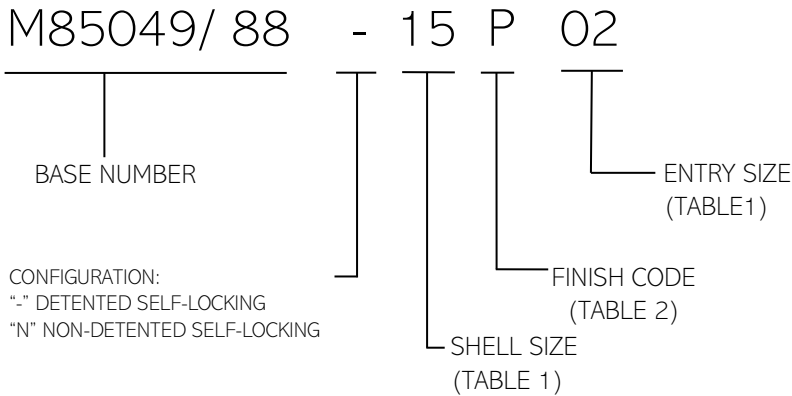
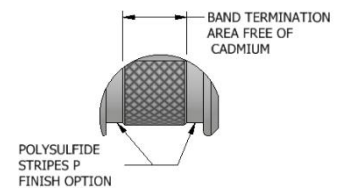
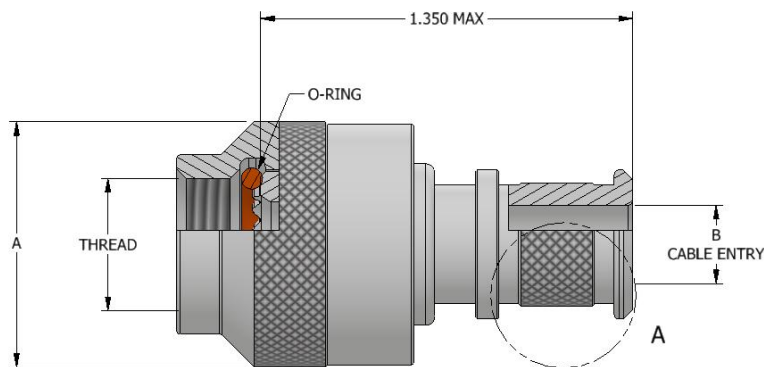

TABLE 2. PLATING CODE	
CODE	DESCRIPTION
G	ELECTROLESS NICKEL (SPACE GRADE)
N	ELECTROLESS NICKEL
P	CADMIUM OLIVE DRAB OVER ELECTROLESS NICKEL (SELECTIVE PLATING)
W	CADMIUM OLIVE DRAB
X	NICKEL FLUOROCARBON POLYMER
Z	ZINC NICKEL
YP	PURE DENSE ELECTRODEPOSITED ALUMINUM OVER ELECTROLESS NICKEL (SELECTIVE PLATING)
ZP	ZINC NICKEL OVER ELECTROLESS NICKEL (SELECTIVE PLATING)

ALUMINUM ALLOY IN ACCORDANCE WITH AS85049.

TABLE 1. SHELL SIZE AND DIMENSIONS				
SHELL SIZE	A MAX DIA	B DIA +.025 (.64) -.010 (.25) ENTRY SIZE		THREAD
		02	03	
9	.858 (21.8)	N/A	.250 (6.4)	M12X1.0-6H
11	.984 (25.0)	N/A	.312 (7.9)	M15X1.0-6H
13	1.157 (29.4)	.312 (7.9)	.438 (11.1)	M18X1.0-6H
15	1.279 (32.5)	.438 (11.1)	.562 (14.3)	M22X1.0-6H
17	1.406 (35.7)	.500 (12.7)	.625 (15.9)	M25X1.0-6H
19	1.516 (38.5)	.625 (15.9)	.750 (19.1)	M28X1.0-6H
21	1.642 (41.7)	.625 (15.9)	.812 (20.6)	M31X1.0-6H
23	1.768 (44.9)	.688 (17.5)	.938 (23.8)	M34X1.0-6H
25	1.889 (48.0)	.750 (19.1)	1.000 (25.4)	M37X1.0-6H



DETAIL A

NOTES:

- 1.METRIC DIMENSIONS (mm) ARE IN PARENTHESES.
- 2.FOR COMPLETE DIMENSIONS, SEE THE APPLICABLE MILITARY SPECIFICATION.
- 3.FOR USE WITH AS85049/128 BANDS.



AS85049/89

BACKSHELL, 45°, SELF-LOCKING, SHIELD BAND TERMINATION (RFI/EMI) (FOR MIL-DTL-38999 SERIES III AND IV CONNECTORS)

PART NUMBER DEVELOPMENT

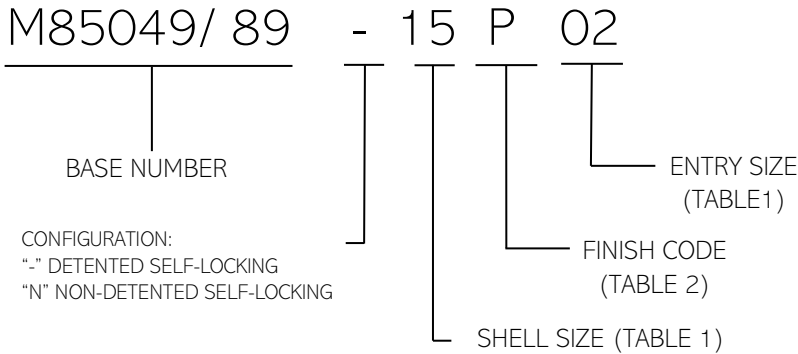

CODE	DESCRIPTION
G	ELECTROLESS NICKEL (SPACE GRADE)
N	ELECTROLESS NICKEL
P	CADMIUM OLIVE DRAB OVER ELECTROLESS NICKEL (SELECTIVE PLATING)
W	CADMIUM OLIVE DRAB
X	NICKEL FLUOROCARBON POLYMER
Z	ZINC NICKEL
YP	PURE DENSE ELECTRODEPOSITED ALUMINUM OVER ELECTROLESS NICKEL (SELECTIVE PLATING)
ZP	ZINC NICKEL OVER ELECTROLESS NICKEL (SELECTIVE PLATING)

ALUMINUM ALLOY IN ACCORDANCE WITH AS85049.

SHELL SIZE	A MAX DIA	B DIA +.025 (.64) -.010 (.25) ENTRY SIZE		D MAX DIM	E MAX DIM	THREAD
		02	03			
9	.858 (21.8)	N/A	.250 (6.4)	1.01 (25.7)	1.16 (29.5)	M12X1.0-6H
11	.984 (25.0)	N/A	.312 (7.9)	1.03 (26.2)	1.19 (30.2)	M15X1.0-6H
13	1.157 (29.4)	.312 (7.9)	.438 (11.1)	1.06 (26.9)	1.21 (30.7)	M18X1.0-6H
15	1.279 (32.5)	.438 (11.1)	.562 (14.3)	1.08 (27.4)	1.24 (31.5)	M22X1.0-6H
17	1.406 (35.7)	.500 (12.7)	.625 (15.9)	1.11 (28.2)	1.26 (32.0)	M25X1.0-6H
19	1.516 (38.5)	.625 (15.9)	.750 (19.1)	1.12 (28.4)	1.27 (32.3)	M28X1.0-6H
21	1.642 (41.7)	.625 (15.9)	.812 (20.6)	1.15 (29.2)	1.30 (33.0)	M31X1.0-6H
23	1.768 (44.9)	.688 (17.5)	.938 (23.8)	1.17 (29.7)	1.33 (33.8)	M34X1.0-6H
25	1.889 (48.0)	.750 (19.1)	1.000 (25.4)	1.20 (30.5)	1.35 (34.3)	M37X1.0-6H

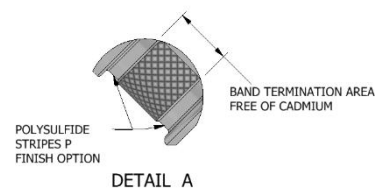
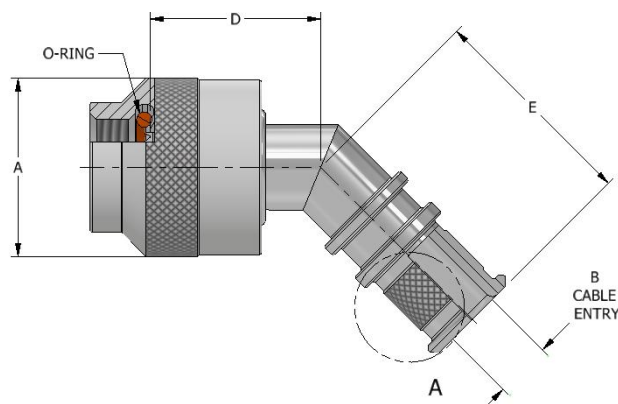

NOTES:

- 1.METRIC DIMENSIONS (mm) ARE IN PARENTHESES.
- 2.FOR COMPLETE DIMENSIONS, SEE THE APPLICABLE MILITARY SPECIFICATION.
- 3.FOR USE WITH AS85049/128 BANDS.



AS85049/90

BACKSHELL, 90°, SELF-LOCKING, SHIELD BAND TERMINATION (RFI/EMI) (FOR MIL-DTL-38999 SERIES III AND IV CONNECTORS)

PART NUMBER DEVELOPMENT

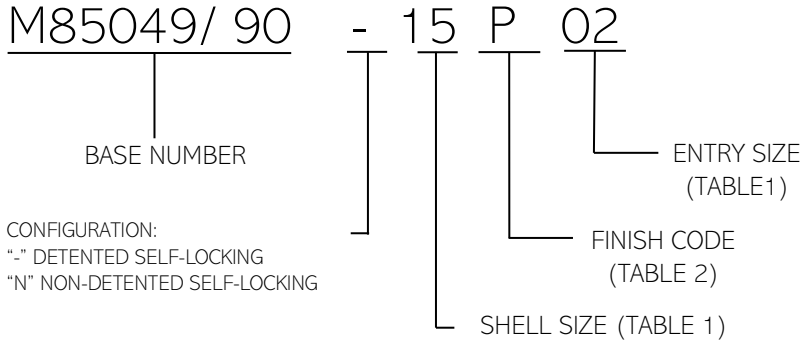
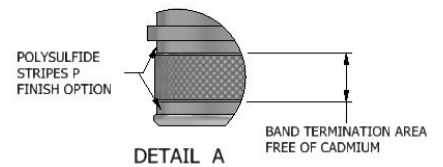
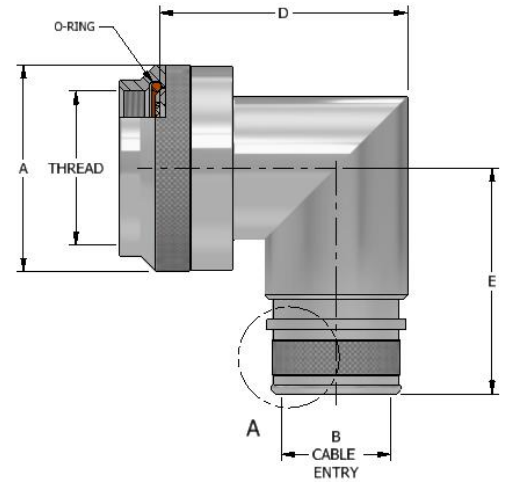

TABLE 1. SHELL SIZE AND DIMENSIONS

SHELL SIZE	A MAX DIA	B DIA +.025 (.64) -.010 (.25) ENTRY SIZE		D MAX DIA	E MAX DIA	THREAD
		02	03			
9	.858 (21.79)	N/A	.250 (6.35)	1.375 (34.93)	1.417 (35.99)	M12X1.0-6H
11	.984 (24.99)	N/A	.312 (7.92)	1.437 (36.50)	1.480 (37.59)	M15X1.0-6H
13	1.157 (29.39)	.312 (7.92)	.438 (11.13)	1.562 (39.67)	1.553 (39.45)	M18X1.0-6H
15	1.279 (32.49)	.438 (11.13)	.562 (14.27)	1.687 (42.85)	1.614 (41.00)	M22X1.0-6H
17	1.406 (35.71)	.500 (12.70)	.625 (15.88)	1.750 (44.45)	1.678 (42.62)	M25X1.0-6H
19	1.516 (38.51)	.625 (15.88)	.750 (19.05)	1.875 (47.63)	1.773 (45.03)	M28X1.0-6H
21	1.642 (41.71)	.625 (15.88)	.812 (20.62)	1.938 (49.23)	1.796 (45.62)	M31X1.0-6H
23	1.768 (44.91)	.688 (17.48)	.938 (23.83)	2.062 (52.37)	1.859 (47.22)	M34X1.0-6H
25	1.889 (47.98)	.750 (19.05)	1.000 (25.40)	2.125 (53.98)	1.919 (48.74)	M37X1.0-6H

TABLE 2. PLATING CODE

CODE	DESCRIPTION	MATERIAL	
G	ELECTROLESS NICKEL (SPACE GRADE)	ALUMINUM ALLOY IN ACCORDANCE WITH AS85049	
N	ELECTROLESS NICKEL		
P	CADMIUM OLIVE DRAB OVER ELECTROLESS NICKEL (SELECTIVE PLATING)		
W	CADMIUM OLIVE DRAB		
X	NICKEL FLUOROCARBON POLYMER		
Z	ZINC NICKEL		
YP	PURE DENSE ELECTRODEPOSITED ALUMINUM OVER ELECTROLESS NICKEL (SELECTIVE PLATING)		
ZP	ZINC NICKEL OVER ELECTROLESS NICKEL (SELECTIVE PLATING)		
J	CADMIUM OLIVE DRAB		COMPOSITE IN ACCORDANCE WITH AS85049
L	CADMIUM OLIVE DRAB OVER ELECTROLESS NICKEL (SELECTIVE PLATING)		
M	ELECTROLESS NICKEL		
XC	NICKEL FLUOROCARBON POLYMER		
YL	PURE DENSE ELECTRODEPOSITED ALUMINUM (SELECTIVE PLATING)		
ZC	ZINC NICKEL		
ZL	ZINC NICKEL (SELECTIVE PLATING)		



NOTES:

- 1.METRIC DIMENSIONS (mm) ARE IN PARENTHESES.
- 2.FOR COMPLETE DIMENSIONS, SEE THE APPLICABLE MILITARY SPECIFICATION.
- 3.FOR USE WITH AS85049/128 BANDS.



AS85049/103

STRAIN RELIEF, STRAIGHT, SELF-LOCKING

(FOR MIL-DTL-38999 SERIES III AND IV CONNECTORS)

PART NUMBER DEVELOPMENT

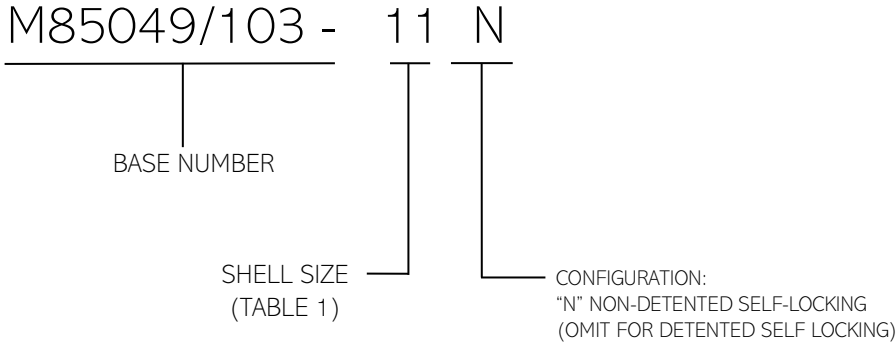
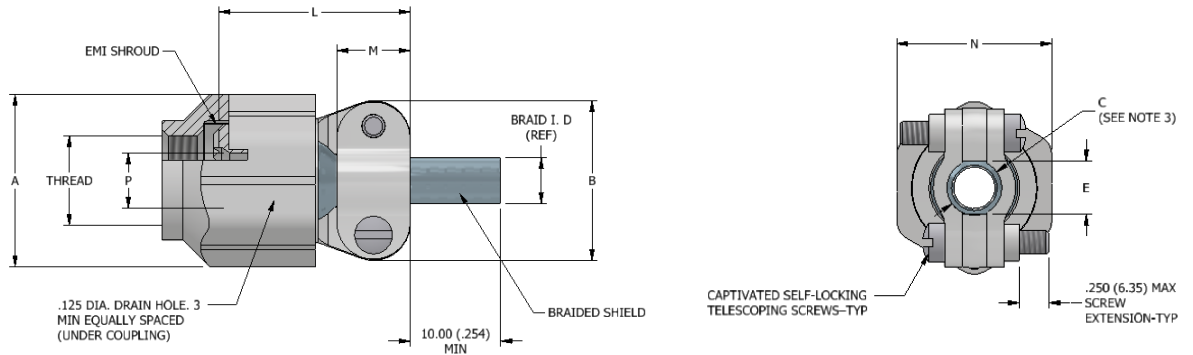

TABLE 1. SHELL SIZES AND DIMENSIONS

SHELL SIZE	A MAX DIA	B MAX	C ±.031 DIA.	E MIN	L	M ±.03	N HEX	P MIN	BRAID I.D. REF	SCREW SIZE	THREAD
9	.858 (21.79)	.98 (24.89)	.265 (6.73)	.229 (5.82)	.780/.939 (19.81/23.85)	.375 (9.53)	.750/.736 (19.05/18.69)	.264 (6.71)	.375 (9.53)	4-40	M12X1.0-6H
11	.984 (24.99)	1.05 (26.67)	.310 (7.87)	.274 (6.96)	.860/1.059 (21.84/26.90)	.375 (9.53)	.875/.860 (22.23/21.84)	.390 (9.91)	.375 (9.53)	4-40	M15X1.0-6H
13	1.157 (29.39)	1.20 (30.48)	.390 (9.91)	.354 (8.99)	.950/1.199 (24.10/30.45)	.406 (10.31)	1.000/.980 (25.40/24.89)	.504 (12.80)	.500 (1.27)	6-32	M18X1.0-6H
15	1.280 (32.51)	1.30 (33.02)	.506 (12.85)	.470 (11.94)	.950/1.199 (24.13/30.45)	.406 (10.31)	1.125/1.100 (28.58/27.94)	.630 (16.00)	.500 (1.27)	6-32	M22X1.0-6H
17	1.406 (35.71)	1.44 (36.58)	.591 (15.01)	.555 (14.10)	1.080/1.329 (27.43/33.75)	.406 (10.31)	1.250/1.224 (31.75/31.09)	.756 (19.20)	.781 (19.84)	6-32	M25X1.0-6H
19	1.516 (38.51)	1.56 (39.62)	.661 (16.79)	.625 (15.88)	1.140/1.509 (28.9/38.33)	.406 (10.31)	1.375/1.348 (34.93/34.24)	.843 (21.41)	.781 (19.84)	6-32	M28X1.0-6H
21	1.642 (41.71)	1.69 (42.92)	.744 (18.90)	.708 (17.98)	1.200/1.609 (30.5/40.87)	.406 (10.31)	1.500/1.469 (38.10/37.31)	.969 (24.61)	1.000 (25.40)	6-32	M31X1.0-6H
23	1.768 (44.91)	1.77 (44.96)	.826 (20.98)	.790 (20.07)	1.330/1.759 (33.8/44.68)	.406 (10.31)	1.625/1.581 (41.28/40.16)	1.091 (27.71)	1.000 (25.40)	6-32	M34X1.0-6H
25	1.890 (48.01)	1.89 (48.01)	.896 (22.76)	.860 (21.84)	1.450/1.859 (36.8/47.22)	.406 (10.31)	1.750/1.690 (44.45/42.93)	1.217 (30.91)	1.250 (31.75)	6-32	M37X1.0-6H



NOTES:

1. METRIC DIMENSIONS (mm) ARE IN PARENTHESES.
2. FOR COMPLETE DIMENSIONS, SEE THE APPLICABLE MILITARY SPECIFICATION.
3. CABLE ENTRY IS MEASURED WITH SADDLE BARS CLOSED AND BOTTOMED ON CLAMP EARS.



AS85049/109

BACKSHELL, STRAIGHT, NON-SELF LOCKING AND SELF LOCKING, PRE-ATTACHED SHIELD TERMINATION (RFI/EMI), BOOT ACCOMMODATION. (FOR MIL-DTL-83723 SERIES III CONNECTORS)

PART NUMBER DEVELOPMENT

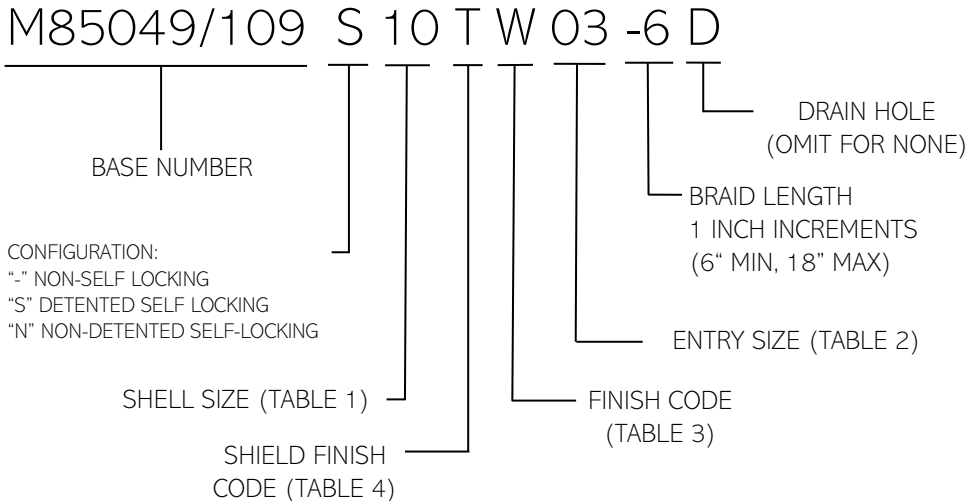

TABLE 4. SHIELD PLATING CODE	
CODE	DESCRIPTION
K	NICKEL
T	TIN

COPPER IN ACCORDANCE WITH AS85049

TABLE 3. PLATING CODE	
CODE	DESCRIPTION
N	ELECTROLESS NICKEL
W	CADMIUM OLIVE DRAB OVER ELECTROLESS NICKEL
X	NICKEL FLUOROCARBON POLYMER
Z	ZINC NICKEL

ALUMINUM ALLOY IN ACCORDANCE WITH AS85049.

TABLE 1. SHELL SIZE AND DIMENSIONS			
SHELL SIZE	ALLOWABLE CABLE ENTRY SIZE TABLE 2	A MAX DIA	THREAD CLASS 2B
3	1	.885 (22.48)	.5625-24 UNEF
8	1	.885 (22.48)	.500-20 UNF
10	01-03	1.010 (25.65)	.625-24 UNEF
12	01-05	1.135 (28.83)	.750-20 UNEF
14	02-06	1.260 (32.00)	.875-20 UNEF
16	04-08	1.385 (35.18)	1.000-20 UNEF
18	05-09	1.510 (38.35)	1.0625-18 UNEF
20	07-11	1.635 (41.53)	1.1875-18 UNEF
22	09-13	1.760 (44.70)	1.3125-18 UNEF
24	11-14	1.885 (47.88)	1.4375-18 UNEF
28	14-16	2.135 (54.23)	1.750-18 UNS
32	16-17	2.395 (60.83)	2.000-18 UNS
36	17-19	2.635 (66.93)	2.250-16 UN
40	19-21	2.885 (73.28)	2.500-16 UN
44	21-23	3.135 (79.63)	2.750-16 UN
48	23-25	3.385 (85.98)	3.000-16 UN
61	12-14	1.885 (47.88)	1.500-18 UNEF

TABLE 2. CABLE ENTRY DIMENSIONS			
ENTRY SIZE	W ±.020 (.51)	Y +.008 (.20) - .000	Z MAX
01	.250 (6.35)	.044 (1.12)	.560 (14.22)
02	.312 (7.92)	.044 (1.12)	.630 (16.00)
03	.375 (9.53)	.044 (1.12)	.690 (17.53)
04	.438 (11.13)	.044 (1.12)	.750 (19.05)
05	.500 (12.70)	.044 (1.12)	.820 (20.83)
06	.562 (14.27)	.044 (1.12)	.890 (22.61)
07	.625 (15.88)	.044 (1.12)	.950 (24.13)
08	.688 (17.48)	.044 (1.12)	1.020 (25.91)
09	.750 (19.05)	.069 (1.75)	1.070 (27.18)
10	.812 (20.62)	.069 (1.75)	1.130 (28.70)
11	.875 (22.23)	.069 (1.75)	1.190 (30.23)
12	.938 (23.83)	.069 (1.75)	1.260 (32.00)
13	1.000 (25.40)	.069 (1.75)	1.320 (33.53)
14	1.125 (28.58)	.069 (1.75)	1.470 (37.34)
15	1.250 (31.75)	.069 (1.75)	1.600 (40.64)
16	1.375 (34.93)	.069 (1.75)	1.710 (43.43)
17	1.500 (38.10)	.086 (2.18)	1.840 (46.74)
18	1.625 (41.28)	.086 (2.18)	2.000 (50.80)
19	1.750 (44.45)	.086 (2.18)	2.120 (53.85)
20	1.875 (47.63)	.086 (2.18)	2.270 (57.66)
21	2.000 (50.80)	.086 (2.18)	2.440 (61.98)
22	2.125 (53.98)	.086 (2.18)	2.600 (66.04)
23	2.250 (57.15)	.086 (2.18)	2.750 (69.85)
24	2.375 (60.33)	.086 (2.18)	2.900 (73.66)
25	2.500 (63.50)	.086 (2.18)	3.060 (77.72)

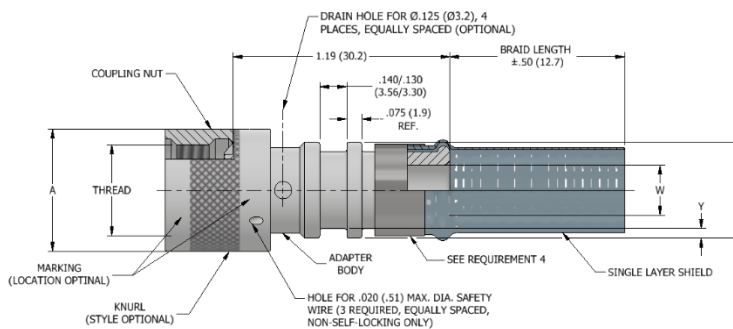

NOTES:

- 1.METRIC DIMENSIONS (mm) ARE IN PARENTHESES.
- 2.FOR COMPLETE DIMENSIONS, SEE THE APPLICABLE MILITARY SPECIFICATION.
- 3.PIG TAIL TERMINATED BRAID MATERIAL SHALL BE IN ACCORDANCE WITH TABLE 4. BRAID LENGTH IS DEFINED BY THE IDENTIFYING NUMBER (PIN).
- 4.TERMINATION BAND CONFIGURATION IS NOT CONTROLLED. BAND WITH BUCKLE MAY EXCEED THE "Z" DIMENSION (SEE TABLE 2) PROVIDED THE BAND DOES NOT INTERFERE WITH BOOT ATTACHMENT. BAND MATERIAL SHALL BE EITHER COPPER OR STAINLESS STEEL.
- 5.THE ADAPTER SURFACE UNDER THE BRAID SHALL BE RIBBED, KNURLED, OR HAVE A SURFACE ROUGHNESS OF 125 Ra MINIMUM IN ACCORDANCE WITH ANSI B46.1).



AS85049/112

BACKSHELL, STRAIGHT, NON-SELF LOCKING AND SELF LOCKING, PRE-ATTACHED SHIELD TERMINATION (RFI/EMI), BOOT ACCOMMODATION. (FOR MIL-DTL-38999 SERIES I AND II CONNECTORS)

PART NUMBER DEVELOPMENT

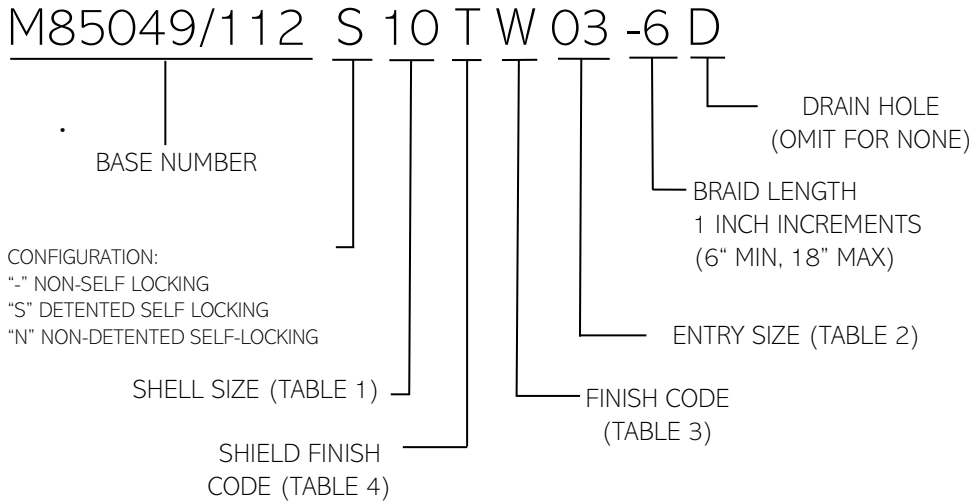

TABLE 4. SHIELD PLATING CODE	
CODE	DESCRIPTION
K	NICKEL
T	TIN

COPPER IN ACCORDANCE WITH AS85049

TABLE 3. PLATING CODE	
CODE	DESCRIPTION
N	ELECTROLESS NICKEL
W	CADMIUM OLIVE DRAB OVER ELECTROLESS NICKEL
X	NICKEL FLUOROCARBON POLYMER
Z	ZINC NICKEL

ALUMINUM ALLOY IN ACCORDANCE WITH AS85049.

TABLE 1. SHELL SIZE AND DIMENSION			
SHELL SIZE	ALLOWABLE CABLE ENTRY SIZE TABLE 2	A MAX DIA	THREAD UNEF-2B
8	1	.858 (21.79)	.4375-28
10	01-03	.984 (24.99)	.5625-24
12	01-05	1.157 (29.39)	.6875-24
14	03-07	1.279 (32.49)	.8125-20
16	05-09	1.406 (35.71)	.9375-20
18	06-10	1.516 (38.51)	1.0625-18
20	08-12	1.642 (41.71)	1.1875-18
22	09-13	1.768 (44.91)	1.3125-18
24	10-14	1.889 (47.98)	1.4375-18

TABLE 2. CABLE ENTRY DIMENSIONS			
ENTRY SIZE	W ±.020 (.51)	Y +.008 (.20) - .000	Z MAX
1	.250 (6.35)	.044 (1.12)	.560 (14.22)
2	.312 (7.92)	.044 (1.12)	.630 (16.00)
3	.375 (9.53)	.044 (1.12)	.690 (17.53)
4	.438 (11.13)	.044 (1.12)	.750 (19.05)
5	.500 (12.70)	.044 (1.12)	.820 (20.83)
6	.562 (14.27)	.044 (1.12)	.890 (22.61)
7	.625 (15.88)	.044 (1.12)	.950 (24.13)
8	.688 (17.48)	.044 (1.12)	1.020 (25.91)
9	.750 (19.05)	.069 (1.75)	1.070 (27.18)
10	.812 (20.62)	.069 (1.75)	1.130 (28.70)
11	.875 (22.23)	.069 (1.75)	1.190 (30.23)
12	.938 (23.83)	.069 (1.75)	1.260 (32.00)
13	1.000 (25.40)	.069 (1.75)	1.320 (33.53)
14	1.125 (28.58)	.069 (1.75)	1.470 (37.34)

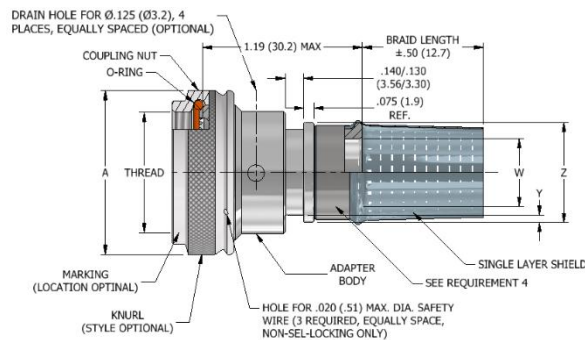

NOTES:

1. METRIC DIMENSIONS (mm) ARE IN PARENTHESES.
2. FOR COMPLETE DIMENSIONS, SEE THE APPLICABLE MILITARY SPECIFICATION.
3. PIG TAIL TERMINATED BRAID MATERIAL SHALL BE IN ACCORDANCE WITH TABLE 4. BRAID LENGTH IS DEFINED BY THE IDENTIFYING NUMBER (PIN).
4. TERMINATION BAND CONFIGURATION IS NOT CONTROLLED. BAND WITH BUCKLE MAY EXCEED THE "Z" DIMENSION (SEE TABLE 2) PROVIDED THE BAND DOES NOT INTERFERE WITH BOOT ATTACHMENT. BAND MATERIAL SHALL BE EITHER COPPER OR STAINLESS STEEL.
5. THE ADAPTER SURFACE UNDER THE BRAID SHALL BE RIBBED, KNURLED, OR HAVE A SURFACE ROUGHNESS OF 125 Ra MINIMUM IN ACCORDANCE WITH ANSI B46.1.



AS85049/114

BACKSHELL, 90°, NON-SELF LOCKING AND SELF LOCKING, PRE-ATTACHED SHIELD TERMINATION (RFI/EMI), BOOT ACCOMMODATION.

(FOR MIL-DTL-38999 SERIES I AND II CONNECTORS)

PART NUMBER DEVELOPMENT

M85049/114 S 10 T W 03 -6 D

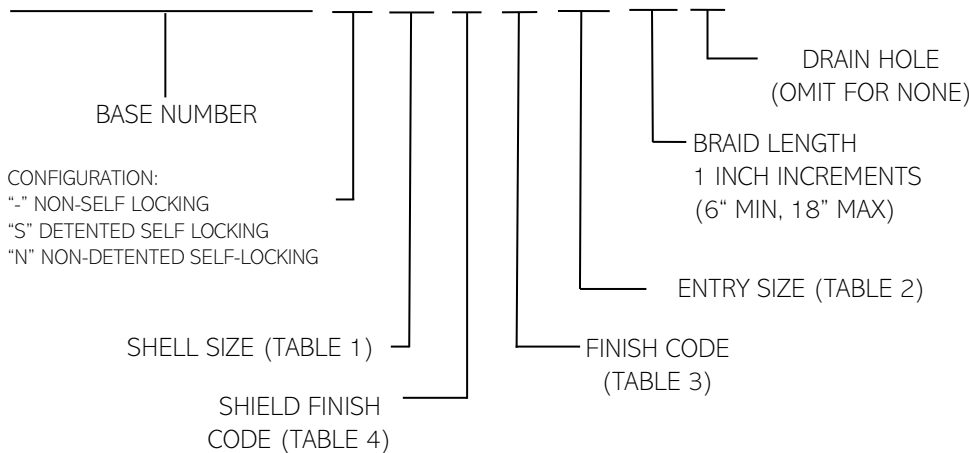

TABLE 2. CABLE ENTRY DIMENSIONS			
ENTRY SIZE	W ±.020 (.51)	Y +.008 (.20) - .000	Z MAX
1	.250 (6.35)	.044 (1.12)	.560 (14.22)
2	.312 (7.92)	.044 (1.12)	.630 (16.00)
3	.375 (9.53)	.044 (1.12)	.690 (17.53)
4	.438 (11.13)	.044 (1.12)	.750 (19.05)
5	.500 (12.70)	.044 (1.12)	.820 (20.83)
6	.562 (14.27)	.044 (1.12)	.890 (22.61)
7	.625 (15.88)	.044 (1.12)	.950 (24.13)
8	.688 (17.48)	.044 (1.12)	1.020 (25.91)
9	.750 (19.05)	.069 (1.75)	1.070 (27.18)
10	.812 (20.62)	.069 (1.75)	1.130 (28.70)
11	.875 (22.23)	.069 (1.75)	1.190 (30.23)
12	.938 (23.83)	.069 (1.75)	1.260 (32.00)
13	1.000 (25.40)	.069 (1.75)	1.320 (33.53)
14	1.125 (28.58)	.069 (1.75)	1.470 (37.34)

TABLE 4. SHIELD PLATING CODE	
CODE	DESCRIPTION
K	NICKEL
T	TIN

COPPER IN ACCORDANCE WITH AS85049 AS85049

TABLE 3. PLATING CODE	
CODE	DESCRIPTION
N	ELECTROLESS NICKEL
W	CADMIUM OLIVE DRAB OVER ELECTROLESS NICKEL
X	NICKEL FLUOROCARBON POLYMER
Z	ZINC NICKEL

ALUMINUM ALLOY IN ACCORDANCE WITH AS85049.

TABLE 1. SHELL SIZE AND DIMENSIONS					
SHELL SIZE	ALLOWABLE CABLE ENTRY SIZE TABLE 2	A MAX DIA	H MAX DIA	J MAX DIA	THREAD UNEF-2B
8	1	.858 (21.79)	1.730 (43.94)	1.070 (27.18)	.4375-28
10	01-03	.984 (24.99)	1.850 (46.99)	1.190 (30.23)	.5625-24
12	01-05	1.157 (29.39)	1.870 (47.50)	1.320 (33.53)	.6875-24
14	03-07	1.279 (32.49)	1.940 (49.28)	1.440 (36.58)	.8125-20
16	05-09	1.406 (35.71)	2.030 (51.56)	1.570 (39.88)	.9375-20
18	06-10	1.516 (38.51)	2.200 (55.88)	1.750 (44.45)	1.0625-18
20	08-12	1.642 (41.71)	2.200 (55.88)	1.750 (44.45)	1.1875-18
22	09-13	1.768 (44.91)	2.310 (58.67)	2.000 (50.80)	1.3125-18
24	10-14	1.889 (47.98)	2.310 (58.67)	2.000 (50.80)	1.4375-18

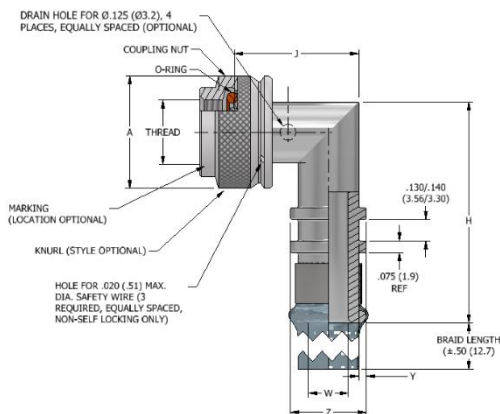

NOTES:

1. METRIC DIMENSIONS (mm) ARE IN PARENTHESES.
2. FOR COMPLETE DIMENSIONS, SEE THE APPLICABLE MILITARY SPECIFICATION.
3. PIG TAIL TERMINATED BRAID MATERIAL SHALL BE IN ACCORDANCE WITH TABLE 4. BRAID LENGTH IS DEFINED BY THE IDENTIFYING NUMBER (PIN).
4. TERMINATION BAND CONFIGURATION IS NOT CONTROLLED. BAND WITH BUCKLE MAY EXCEED THE "Z" DIMENSION (SEE TABLE 2) PROVIDED THE BAND DOES NOT INTERFERE WITH BOOT ATTACHMENT. BAND MATERIAL SHALL BE EITHER COPPER OR STAINLESS STEEL.
5. THE ADAPTER SURFACE UNDER THE BRAID SHALL BE RIBBED, KNURLED, OR HAVE A SURFACE ROUGHNESS OF 125 Ra MINIMUM IN ACCORDANCE WITH ANSI B46.1.



AS85049/115

BACKSHELL, STRAIGHT, NON-SELF LOCKING AND SELF LOCKING, PRE-ATTACHED SHIELD TERMINATION (RFI/EMI), BOOT ACCOMMODATION. (FOR MIL-DTL-38999 SERIES III AND IV CONNECTORS)

PART NUMBER DEVELOPMENT

M85049/115 S 11 T W 03 -6 D

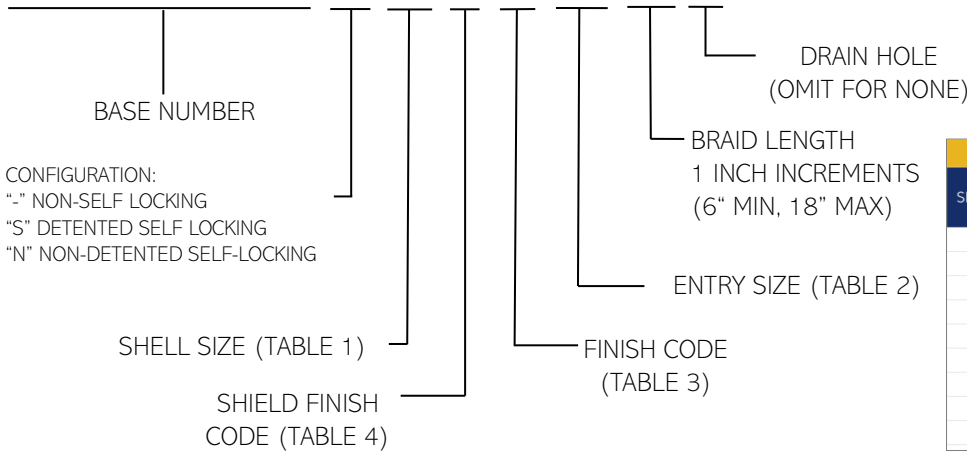

SHELL SIZE	ALLOWABLE CABLE ENTRY SIZE TABLE 2	A MAX DIA	THREAD
9	1	.858 (21.79)	M12X1.0-6H
11	01-03	.984 (24.99)	M15X1.0-6H
13	01-05	1.157 (29.39)	M18X1.0-6H
15	03-07	1.279 (32.49)	M22X1.0-6H
17	05-09	1.406 (35.71)	M25X1.0-6H
19	06-10	1.516 (38.51)	M28X1.0-6H
21	08-12	1.642 (41.71)	M31X1.0-6H
23	09-13	1.768 (44.91)	M34X1.0-6H
25	10-14	1.889 (47.98)	M37X1.0-6H

CODE	DESCRIPTION
K	NICKEL
T	TIN

COPPER IN ACCORDANCE WITH AS85049

CODE	DESCRIPTION
N	ELECTROLESS NICKEL
W	CADMIUM OLIVE DRAB OVER ELECTROLESS NICKEL
X	NICKEL FLUOROCARBON POLYMER
Z	ZINC NICKEL

ALUMINUM ALLOY IN ACCORDANCE WITH AS85049.

ENTRY SIZE	W ±.020 (.51)	Y +.008 (.20) - .000	Z MAX
1	.250 (6.35)	.044 (1.12)	.560 (14.22)
2	.312 (7.92)	.044 (1.12)	.630 (16.00)
3	.375 (9.53)	.044 (1.12)	.690 (17.53)
4	.438 (11.13)	.044 (1.12)	.750 (19.05)
5	.500 (12.70)	.044 (1.12)	.820 (20.83)
6	.562 (14.27)	.044 (1.12)	.890 (22.61)
7	.625 (15.88)	.044 (1.12)	.950 (24.13)
8	.688 (17.48)	.044 (1.12)	1.020 (25.91)
9	.750 (19.05)	.069 (1.75)	1.070 (27.18)
10	.812 (20.62)	.069 (1.75)	1.130 (28.70)
11	.875 (22.23)	.069 (1.75)	1.190 (30.23)
12	.938 (23.83)	.069 (1.75)	1.260 (32.00)
13	1.000 (25.40)	.069 (1.75)	1.320 (33.53)
14	1.125 (28.58)	.069 (1.75)	1.470 (37.34)

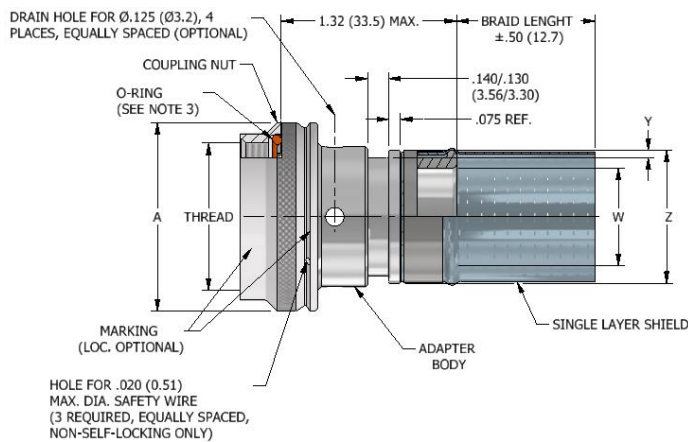

NOTES:

1. METRIC DIMENSIONS (mm) ARE IN PARENTHESES.
2. FOR COMPLETE DIMENSIONS, SEE THE APPLICABLE MILITARY SPECIFICATION.
3. O-RING NOT REQUIRED WHEN DRAIN HOLE OPTION IS SPECIFIED.
4. TERMINATION BAND CONFIGURATION IS NOT CONTROLLED. BAND WITH BUCKLE MAY EXCEED THE "Z" DIMENSION (SEE TABLE 2) PROVIDED THE BAND DOES NOT INTERFERE WITH BOOT ATTACHMENT. BAND MATERIAL SHALL BE EITHER COPPER OR STAINLESS STEEL.

